

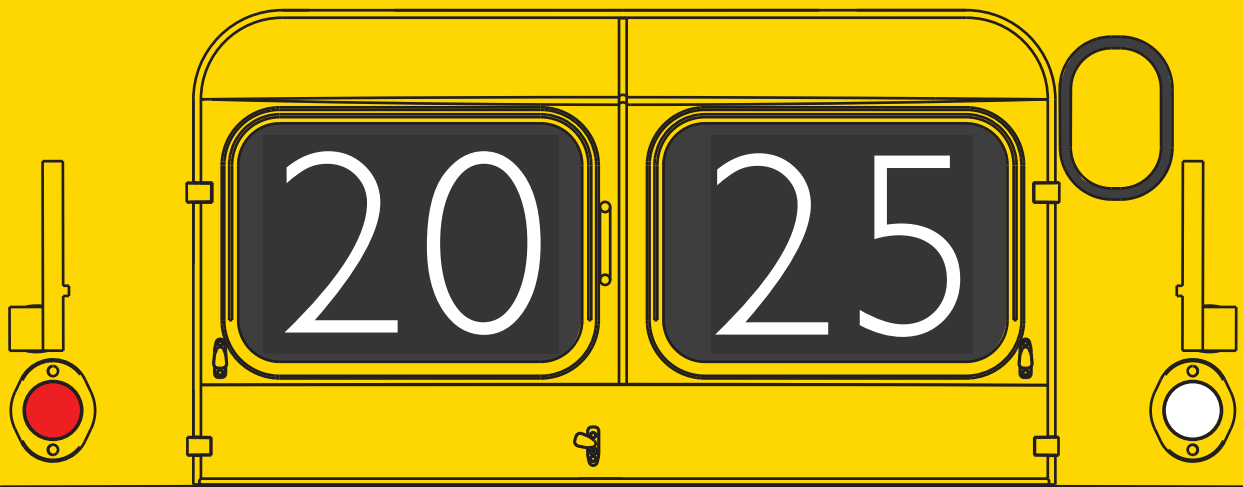

HELJAN



UK 'OO' AND 'O' GAUGE PRODUCTS



**BONUS
CONTENT!**
TRAIN
FORMATIONS

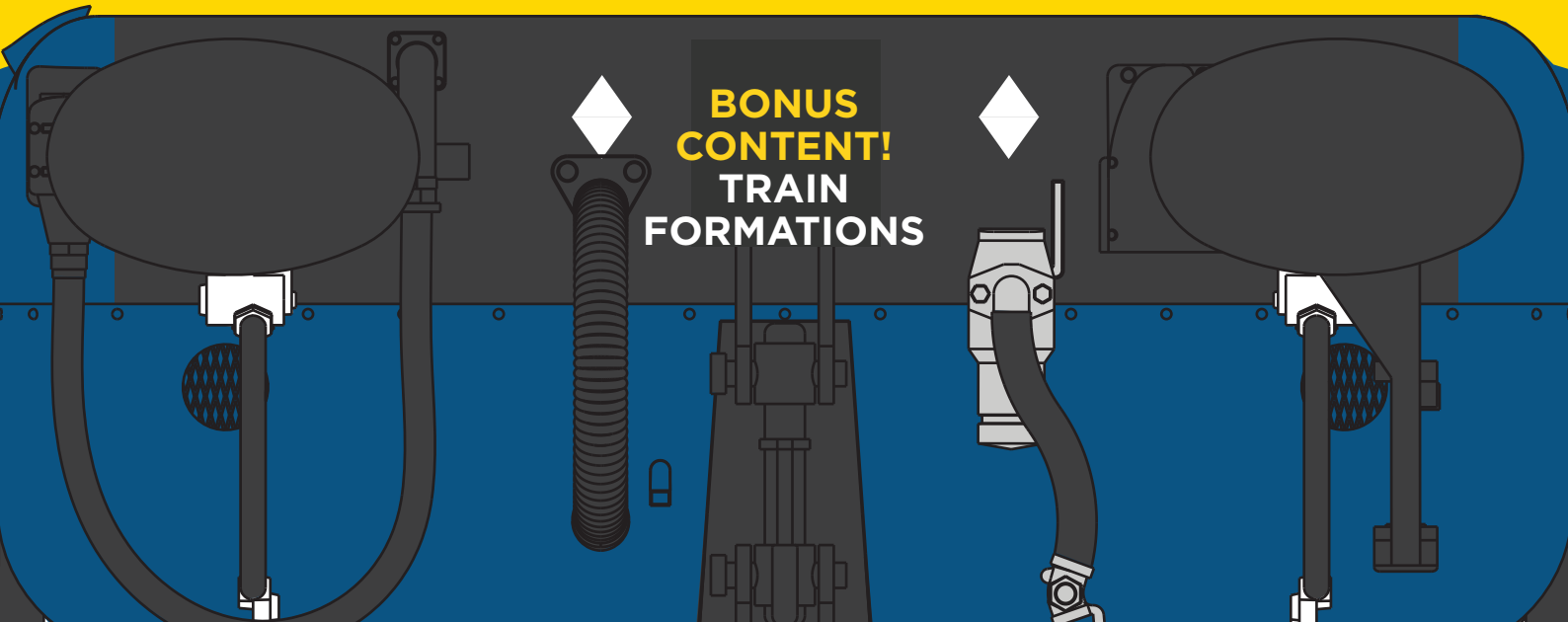



Modelmakers to the World Since 1957

Quality Models Built to Tackle The Toughest Jobs



Locomotives, Coaching Stock and Wagons for 'OO' and 'O' Gauge



Huge Selection of Classic Loco Models from the 1920s to 2000s



Premium Features Delivered as Standard



Welcome!

A very warm welcome to your FREE 2025 HELJAN UK catalogue. Over the last 12 months we've rolled out a wide selection of high-quality models for 'OO' and 'O' gauge, from our superb split headcode Class 37/0 and new generation Class 55 'Deltic' to the all-new 'OO' Class 26, LMS Inspection Saloon and Mk2 coaches in 'O'. Our new Ruston 48DS 4w industrial diesel opens up endless opportunities for new 'O' gauge layouts, offering superb quality and performance at an entry level price of less than £200.

The excitement continues in 2025 with the debut of our all-new 'OO' gauge Class 104 DMU, function-rich Class 153 diesel railcars in 'O' and 'OO' gauge and several other high-specification models such as the 'O' gauge Class 24 and 'OO' Class 42 'Warship'.

Making their first appearance in the catalogue this year are the 'OO' gauge Class 153 and Class 155 DMUs, which will be the first high quality, high specification models of these useful and widely operated second generation diesel units. The all-new 'Warship' also fills a gap in the market for an all-new Class 42 for the first time in more than 40 years.

2025 marks the 200th anniversary of the first public railway in the world - the Stockton & Darlington Railway. We're looking forward to playing our part in the celebrations as they unfold throughout this very special year. However, our biggest story for 2025 is a real railway behemoth - the incredible LNER 'U1' Beyer-Garratt 2-8-0+0-8-2T in 'OO' gauge. This unique locomotive marks its centenary in 2025 and our top-spec model will be a great way for collectors and steam fans to celebrate Britain's largest and most powerful steam locomotive. It is already shaping up to be a very special machine.

And we're not just working on all-new models, we continue to overhaul existing products to bring them up to the latest standards for detail and digitally controlled features. Highlights in 2025 will include the return of the refurbished 'O' gauge Class 31s, 'OO' gauge 'A/B Tank' wagons, new 'OO' Class 86/2s and a superb new centre headcode Class 37 in 'O' gauge.

Look out for announcements of further new items and progress reports at www.heljan.co.uk, the HELJAN Facebook page and across the model railway media.

Contents

003	Essential Information	020	OO Gauge Wagons
004	OO9 Steam Locomotives	024	O Gauge Locomotives
005	OO Gauge Steam Locomotives	033	O Gauge Diesel Railcars/DMUs
006	OO Gauge BR Diesel Locomotives	036	O Gauge Rolling Stock
016	OO Gauge Diesel Railcars	043	OO/O Kits & Accessories
018	OO Gauge Electric Locomotives	046	O Gauge Train Builder

Key to Features

6 PIN Six-pin DCC decoder interface	8 PIN Eight-pin DCC decoder interface	NEXT 18 Next18 DCC decoder interface	21 PIN 21-pin DCC decoder interface	L PIN ESU LokSound L decoder interface
XL PIN ESU LokSound XL decoder interface	DCC READY Designed for easy DCC installation	NEM COUPLERS Interchangeable couplings	SOUND READY Designed for DCC sound equipment	INTERIOR LIGHTS Working interior lights
LIGHTING READY Designed for easy-fit interior light bar	WORKING LIGHTS Working exterior lights	SPRUNG BUFFERS Fitted with working sprung buffers	SOUND FITTED Factory fitted DCC sound	DCC FITTED Factory-fitted decoder
SMOKE READY Designed for installation of smoke unit	NEW FOR 2025! New Releases	info Information		

Visit www.heljan.co.uk to discover more



'OO9' NARROW GAUGE

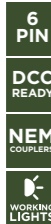

LYNTON & BARNSTAPLE RAILWAY BALDWIN 2-4-2T LYN

Class Profile: Built in the USA by Baldwin, this locomotive joined the Lynton & Barnstaple Railway fleet in 1898, working alongside the British-built Manning, Wardle 2-6-2Ts. A replica is based at the rebuilt Lynton & Barnstaple Railway at Woody Bay.

Built by: Baldwin, USA
Number built: 1
Number series: LYN, SR 762
Service Career: 1898-1935
Region: North Devon
Purpose: Mixed traffic
Status in 2025: 1 x operational replica

AVAILABLE NOW! L&BR BALDWIN LYN

No.	Description
9980	Undecorated Black
9982	L&BR Dark Green E762 LYN
9983	SR Dark Green E762 LYN

'OO' STEAM LOCOMOTIVES



LNER GRESLEY 'O2' 2-8-0

Class Profile: Introduced by the Great Northern Railway in 1921 to a design by Nigel Gresley, these powerful 2-8-0s were built to haul heavy coal and ironstone trains. Several batches were built over a 22-year period by the Great Northern Railway (GNR) and LNER, with numerous improvements such as better cabs and bigger tenders. Our new models depict the 'O2/1', 'O2/2' and 'O2/4' variants with GNR style cabs (original high style and reduced height 'composite loading gauge' type), a choice of GNR and LNER Group Standard tenders and a factory fitted speaker in the tender.

Built by: GNR/LNER Doncaster Works, North British, Glasgow
Number built: 67
Number series: 63922-987 (BR)
Service Career: 1921-63
Region: GNR/LNER, BR Eastern Region
Purpose: Heavy mineral trains
Status in 2025: Extinct

AVAILABLE NOW! GNR/LNER 'O2' 2-8-0

No.	Description
3900	LNER Lined Black O2/2 No. 3501 (GN cab/tender)
3901	BR Late Crest Black O2/2 No. 63937 (GN cab/LNER flush-sided tender)
3902	BR Early Emblem Black O2/2 No. 63933 (GN cab/tender)
3903	BR Late Crest Black O2/2 No. 63940 (GN cab/tender)
3904	BRITISH RAILWAYS Black O2/2 No. 63938 (GN cab/tender)
3930	GNR Lined Grey O2/1 No. 477 (GN high cab/tender)
3931	LNER Black O2/1 No. 3481 (GN high cab/tender)
3932	LNER post-war Black O2/1 No. 3481 (LNER cab/GN tender)
3934	BR Late Crest Black O2/1 No. 63923 (LNER cab/LNER stepped side tender)
3940	LNER Wartime Black O2/4 No. 3479 (LNER cab/GN tender)
3941	BR Early Emblem Black O2/4 No. 63924 (LNER cab/GN tender)
3942	BR Early Emblem Black O2/4 No. 63945 (LNER cab/GN tender)
3943	BR Late Crest Black O2/4 No. 63932 (LNER cab/GN tender)



DUE MID 2025!



LNER 'U1' GARRATT

Class Profile: It was the largest and most powerful steam locomotive ever to run on British rails. The LNER's unique 'U1' 2-8-0+0-8-2T Beyer-Garratt was a true behemoth and our amazing articulated model will bring it back to life in time for the centenary of the prototype in 2025. Packed with authentic details specific to period and livery, our 'U1' is the ultimate expression of steam power for 'OO' layouts and a must for collectors of historic locomotives. The 'U1' features a powerful 16-wheel drive system, working headlamps/headlight, factory fitted speakers and superb detail based on original Beyer, Peacock Ltd works drawings. All versions will be available DCC Ready or with factory-fitted DCC Sound developed by ESU.

Built by: Beyer, Peacock & Co., Gorton Works, Manchester
Number built: 1
Number series: 2395/9999 (LNER), 69999 (BR)
Service Career: 1925-55
Region: Eastern/London Midland
Purpose: Banking on lines with steep gradients
Status in 2025: Extinct

DUE MID-2025! LNER 'U1' 2-8-0+0-8-2T

No.	Description
3000	LNER Lined Black No. 2395
3002	LNER Unlined Black No. 9999 (1946-49)
3003	British Railways Black No. 69999
3004	BR Early Emblem Black No. 69999 (coal fired)
3005	BR Early Emblem Black No. 69999 (oil fired/headlight)



CHOOSE THE RIGHT MODEL FOR YOUR ERA

With so many models and liveries available, it can be difficult to know which suit your chosen period. HELJAN has now adopted the widely used 'era system' for its products, which divides 200 years of British railway history into nine key periods. All new models now have improved box end labels including information on features, specification and era to help you make more informed purchases.

ERA 1

1804-1875
Early Railways

ERA 2

1875-1922
Pre-Grouping

ERA 3

1923-1947 'Big Four'
(LMS, GWR, LNER & SR)

ERA 4

1948-1956 British
Railways Early Emblem

ERA 5

1957-1966 British
Railways Late Crest

ERA 6

1966-1971 British
Rail Blue pre-TOPS

ERA 7

1971-1982 British
Rail Blue TOPS era

ERA 8

1982-1994 British Rail
Sectorisation

ERA 9

1995 onwards -
Privatisation Era

'OO' DIESEL LOCOMOTIVES



RUSTON & HORNSBY 165DE 0-6-0

Class Profile: These 165hp diesel shunters were built in various configurations for industrial railways, with Ruston offering mechanical, hydraulic or electric transmissions and a choice of 0-4-0 or 0-6-0 wheel arrangements. While most of the 164 '165DEs' built in the 1950s/60s were two-axle machines, a small number were delivered as 0-6-0 diesel-electrics, including five to BR Western Region (as produced by HELJAN for *Model Rail* magazine/Kernow Model Rail Centre).

Built by: Ruston & Hornsby, Lincoln
Number built: 164
Number series: N/A

Service Career: 1950s to 1980s
Region: Industrial
Purpose: Shunting
Status in 2025: Five preserved

AVAILABLE NOW! RUSTON 165DE 0-6-0

No.	Description
9770	Industrial Yellow
9771	NCB Dark Green No. 45



BR/YORKSHIRE CLASS 02 0-4-0DH

Class Profile: Built to replace the legendary LYR 0-4-0ST 'Pugs', this class of 20 short-wheelbase 0-4-0 diesel-hydraulic locomotives was based on a standard industrial design. Delivered to depots in the north-west of England for shunting tightly-curved lines around docks and goods depots, many were sold into industry in the late-1960s and subsequently preserved to enjoy a third life at heritage railways. Our model features a factory fitted speaker and two separately controlled light functions.

Built by: Yorkshire Engine Co., Sheffield
Number built: 20 (BR), 50 (industrial)
Number series: D2850-69, 02001/003/004
Service Career: 1960 to 1990s

Region: London Midland/industrial
Purpose: Shunting on tightly curved dock/factory lines
Status in 2025: Seven preserved (D2853/54/58/60/66-68)

DUE EARLY-2025! BR/YORKSHIRE CLASS 02

No.	Description
2840	BR Green D2861 (wasp stripes, red bufferbeam)
2841	BR Green D2864 (wasp stripes, yellow bufferbeam)
2844	BR Green D2004 (wasp stripes, no BR logo) WEATHERED
2847	Arnott & Young Yellow AY1021 (Wasp Stripes)
2850	Industrial Green 'SAM' (ex-D2868) WEATHERED/FADED

DUE EARLY 2025!



BR/RUSTON CLASS 07

Class Profile: A small class of powerful diesel electric shunters built by Ruston & Hornsby to work in and around Southampton Docks, replacing the famous 'USA' 0-6-0T steam locomotives. After withdrawal in the late-1970s, several were sold for industrial use around the UK.

Built by: Ruston & Hornsby, Lincoln
Number built: 14
Number series: D2985-98 (07001-014)
Service Career: 1962-77 (BR), 1977 onwards (industrial)
Region: Southern/industrial
Purpose: Dock shunting
Status in 2025: Five preserved (D2989/94-97)
Notes: V1 models are in original vacuum-brake only condition. V2 models have dual air/vacuum brake equipment.

AVAILABLE NOW! BR/RUSTON CLASS 07

No.	Description
2912	Peakstone Yellow (V2)
2917	BR Blue 2997 (V2)
2918	BR Blue 07011 WEATHERED (V2)
2919	BR Blue 07013 (V2)
2935	BR Green D2994 WEATHERED (V1)
2936	BR Blue 07012 (V1)
2937	BR Green D2998 (V1)
2938	British Army Green 423 (V1)



BR CLASS 14

Class Profile: A 650hp diesel-hydraulic design built by BR's Western Region to replace the legendary GWR Pannier Tanks. However, the type found little work with BR and many ended up with the National Coal Board and British Steel, or even sold abroad. As well as individual locomotives, we offer a train pack based on mid-1960s Western Region ballast trains from Tintern Quarry in the Forest of Dean.

Built by: BR Swindon Works
Number built: 56
Number series: D9500-55
Service Career: 1964-68 (BR), 1968 onwards (industrial)
Region: Western/Eastern/industrial
Purpose: Short-distance trip freight
Status in 2025: 19 preserved

AVAILABLE NOW! BR CLASS 14 0-6-0DH

No.	Description
1412	BR Two-Tone Green D9505
1413	BR Two-Tone Green D9545
1414	Buckminster Quarries S&L Green No.21
1416	National Coal Board Pale Blue D9530
1417	BP Light Green D9524
1420	Train Pack - BR Green D9553 with 4x BR Black 'Dogfish' ballast hoppers





BR/NBL PROTOTYPE 10800

Class Profile: A unique experimental diesel ordered by the LMS but delivered to BR in 1950, 10800 was intended as a possible replacement for mixed traffic tank locomotives on secondary passenger and lighter goods trains. Despite extensive testing on the Midland and Southern regions and modifications to improve performance it was never a reliable machine. After withdrawal in 1959 it was sold to Brush and became an early testbed for AC traction technology, eventually being scrapped in 1976. Our model features a factory-fitted speaker for 'plug-and-play' DCC sound capability and separately switchable light functions.

Built by: North British, Glasgow
Number built: 1
Service Career: 1950-59
Region: London Midland/Southern
Purpose: Mixed traffic
Status in 2025: Extinct

AVAILABLE NOW! BR/NBL PROTOTYPE 10800

No.	Description
1080	BR Early Emblem Black/Silver 10800 (mid-1950s)
1081	BR Early Emblem Black/Silver 10800 (mid-1950s) WEATHERED
1082	BR Early Emblem Black 10800 (late-1950s)
1083	BR Late Crest Green 10800



BR/CLAYTON TYPE 1 - CLASS 17

Class Profile: Experience with the early Type 1 diesels revealed a need for better visibility for crews and the result was the Clayton Type 1 with its characteristic centre cab. Unfortunately, the twin-engined design proved to be unreliable and despite 117 examples being built, the class managed less than a decade in service.

Built by: Clayton/Beyer Peacock
Number built: 117
Number series: D8500-D8616
Service Career: 1962-71 (BR), 1972-82 (industrial)
Region: Scottish, Eastern, North Eastern
Purpose: Light goods and passenger
Status in 2025: One preserved (D8568)

AVAILABLE NOW! BR/CLAYTON CLASS 17

No.	Description
1724	BR Blue D8568 (small yellow panels)
1725	BR Green D8607 (small yellow panels)
1726	BR Green D8599 (small yellow panels) WEATHERED
1727	BR Green D8539 (full yellow ends)
1729	BR Blue 8538 (full yellow ends) WEATHERED

info



BR/SULZER TYPE 2 - CLASS 25

Class Profile: Our Class 25 depicts the later body design variant of the popular and successful BR Derby/Sulzer Type 2, used on almost any type of train across a very wide area of the country from the 1960s until the late-1980s. In the mid-1980s, three locomotives were converted into mobile electric train heating units (ETHELs) for use with MK3 sleeping cars on Scottish Region overnight trains.

Built by: BR Derby Works/Beyer Peacock
Number built: 239
Number series: D5238-99, D7500-D7677 (25088-327)
Service Career: 1963-91
Region: All except Southern
Purpose: Mixed traffic
Status in 2025: 12 preserved (25173/185/191, 25262/265/278/279/283, 25309/313/321/322)
Features: Original circular or revised exhaust ports, optional blanking plates for side grilles and boiler footsteps.

info

AVAILABLE NOW! BR/SULZER CLASS 25

No.	Description
2543	BR Two-Tone Green D5243 (Small Yellow Panels)
2544	BR Blue 25095 (cab front numbers)
2545	BR Blue/Grey 97251 'ETHEL 2'
2546	BR Blue 25904 (domino headcodes)
2547	BR Blue 25301 (domino headcodes)
2548	BR Two-Tone Green 7561 (Full Yellow Ends)
2549	BR Blue 25323 (pre-1976)
2570	BR blue 7513 (Full Yellow Ends)

* Scottish Region train heating unit. Unpowered but with working lights and DCC interface.



BRCW TYPE 2 - CLASS 26/1

Class Profile: An all-new version of our ever-popular BRCW Class 26, featuring a comprehensively upgraded specification, finer detail and a new variant with Far North Line twin headlights. The Class 26s were one of the most successful and long-lived BR 'Pilot Scheme' designs; the initial 20 locomotives were followed by 26 more (Class 26/1) and all were concentrated on the Scottish Region from the 1960s. Used on everything from heavy sleeping car trains to local goods trips, the '26s' proved to be reliable, robust and versatile.

Built by: Birmingham Railway Carriage & Wagon Co., Smethwick
Number built: 47
Number series: D5300-46 (26001-046)
Service Career: 1958-93
Region: Eastern, Scottish
Purpose: Mixed traffic
Status in 2025: 13 preserved (Class 26/0 - 26001/002/004/007/010/011/014. Class 26/1 - 26024/025/035/038/040/043)

info

AVAILABLE NOW! BRCW/SULZER TYPE 2 - CLASS 26

No.	Description
2625	BR Blue 26039 (twin headlights)
2626	BR Blue 26032 (twin headlights) WEATHERED
2641	BR Green D5333 (Small Yellow Panels)
2642	BR Green D5335 (Full Yellow Ends)
2643	BR Blue 26023 (tablet catcher recess)
2644	BR Blue 26042 (dual braked)
2645	Railfreight Red Stripe 26038
2646	Civil Engineers Grey/Yellow 26026



BRCW TYPE 3 - CLASS 33/1

Class Profile: A sub-class converted for push-pull duties between Bournemouth and Weymouth in 1966/67 and subsequently used with '4-TC' trailer sets and various Southern Region EMUs. When not required on the Weymouth line, they worked other SR freight and passenger work. Latest models have 21-pin DCC decoder interface and switchable LED lighting.

Built by: Birmingham Railway Carriage & Wagon Co., Smethwick

Number converted: 19

Number series: 33101-119

Service Career: 1966 onwards

Region: Southern

Purpose: Mixed traffic/push-pull passenger

Status in 2025: 8 preserved

AVAILABLE NOW! BR CLASS 33/1

No.	Description
3346	BR Green D6580 (small yellow panels)
3350	Fragonset Black 33108*
3365	BR Civil Engineers Grey/Yellow 33118
3366	BR Blue 33117 (DCE stripes) WEATHERED
3367	BR Blue 6525
3368	BR Blue 33101 (white cab windows)
3370	Cambrian Trains Green 33103*
3371	BR General Grey 33108*

*Locomotives with HI headlights

21 PIN

DCC READY

NEM COUPLERS

WORKING LIGHTS

SPRUNG BUFFERS

info



BRCW TYPE 3 - CLASS 33/2

Class Profile: Narrow-bodied Class 33s built to work over the gauge-restricted Tonbridge-Hastings line. Nicknamed 'Slim Jims', they worked freight and passenger duties and, like the rest of the class, gradually widened their sphere of operation in later years. Our latest version depicts the '33/2s' in as-built condition with original exhaust arrangement. Latest models have 21-pin DCC decoder interface and switchable LED lighting.

Built by: Birmingham Railway Carriage & Wagon Co., Smethwick

Number built: 12

Number series: D6586-97, 33201-212

Service Career: 1962 onwards

Region: Southern

Purpose: Mixed traffic

Status in 2025: 1 active/3 preserved

AVAILABLE NOW! BRCW 'HASTINGS GAUGE' TYPE 3

No.	Description
3375	BR Green D6586
3376	BR Green D6591 (small yellow panels)
3377	BR Blue D6590 (full yellow ends)
3378	BR Green D6596 (full yellow ends)
3379	BR Green D6594 WEATHERED

AVAILABLE NOW! BR CLASS 33/2

3325	BR General Grey 33201
3338	BR Blue 33202 (orange cantrail line/headlight)
3385	Railfreight Construction 33204
3386	BR Blue 33211 FADED/WEATHERED
3387	Railfreight Distribution 33203
3388	BR Railtour Grey/Yellow 33208 (headlight)

*Locomotives with HI headlights

21 PIN

DCC READY

NEM COUPLERS

WORKING LIGHTS

SPRUNG BUFFERS

info



BR CLASS 35 'HYMEK'

Class Profile: Regarded as the most successful of the Western Region diesel-hydraulic types, these versatile and capable Type 3s worked all kinds of trains from named expresses to local goods and ran across much of southern England, the West Midlands and Wales until the mid-1970s. This new batch of models features an upgraded chassis with 21-pin DCC decoder interface, LED lighting and cab lights.

Built by: Beyer, Peacock Ltd., Gorton Works, Manchester

Number built: 101

Number series: D7000-7100

Service Career: 1961-75

Region: Western/Southern

Purpose: Mixed traffic

Status in 2025: 4 preserved

AVAILABLE NOW! BR/BEYER PEACOCK CLASS 35

No.	Description
3531	BR Green D7041 (small yellow panels) EX-WORKS CONDITION
3532	BR Green D7094 (full yellow ends) WEATHERED
3533	BR Green D7093 (small yellow panels)
3534	BR Blue 7052 (small yellow panels/white windows) WEATHERED
3535	BR Blue D7058 (full yellow ends)
3536	BR Blue D7081 (full yellow ends) WEATHERED

21 PIN

DCC READY

NEM COUPLERS

WORKING LIGHTS

SPRUNG BUFFERS

INTERIOR LIGHTS



HELJAN SPARES & REPLACEMENT PARTS

If you require replacement parts or spares for your HELJAN OO9, OO and O gauge models, please contact Gagemaster, our UK agent, which offers an extensive range of more than 6,000 original parts*.

Gagemaster also provides online access to exploded parts diagrams and price lists, making it easier for you to identify and order the parts you need. Spares can be ordered online or by telephone via the methods shown below.

* Please note that we cannot guarantee the availability of all spare parts for every HELJAN product at all times, especially older models that have been discontinued.

Order online: www.gaugemasterretail.com
(Search Heljan spares)

Order by telephone: 01903 884488



NEW FOR 2025!

DCC SOUND
OPTION ON ALL CLASS 42s

NEW! BR CLASS 42 'WARSHIP'

Class Profile: One of the first new types to enter traffic as part of BR's Modernisation Plan, the Class 42s were derived from the West German V200 diesel-hydraulics. With their stylish and lightweight design they were a stark contrast to the heavy diesel-electrics of the time (see opposite page). Despite being fast and powerful they were quickly superseded on express passenger work by the Class 52 'Westerns' and worked out their short career on a wide range of secondary passenger, parcels and freight duties between London and the West of England. Our new model is the first high-specification 'OO' Class 42 and features a factory fitted speaker, authentic lighting functions and a wide range of authentic detail variations. Two versions are in development - a standard Class 42 (see below) and early prototype locomotives (D800-D812, see above) with train indicator boards, which are available exclusively from Rails of Sheffield.

Built by: BR Swindon Works
Number built: 38
Number series: D800-832/D866-872
Service Career: 1958-72
Region: Western/Southern
Purpose: Mixed Traffic
Status in 2025: Two preserved (D821/D832)

NEW FOR 2025! BR CLASS 42 'WARSHIP'

No.	Description
4240	BR Green D808 <i>Centaur</i> (Full Yellow Ends) DCC READY
42403	BR Green D808 <i>Centaur</i> (Full Yellow Ends) DCC SOUND
4241	BR Maroon D832 <i>Centaur</i> (Small Yellow Panel) DCC READY
42413	BR Maroon D832 <i>Centaur</i> (Small Yellow Panel) DCC SOUND
4242	BR Blue D831 <i>Monarch</i> (Small Yellow Panel) DCC READY
42423	BR Blue D831 <i>Monarch</i> (Small Yellow Panel) DCC SOUND
4243	BR Blue D868 <i>Zephyr</i> (Full Yellow Ends) DCC READY
42433	BR Blue D868 <i>Zephyr</i> (Full Yellow Ends) DCC SOUND
4245	BR Green D826 <i>Jupiter</i> (Small Yellow Panel) DCC READY
42453	BR Green D826 <i>Jupiter</i> (Small Yellow Panel) DCC SOUND



info

- 21 PIN
- DCC READY
- NEM COUPLERS
- WORKING LIGHTS
- SPRUNG BUFFERS
- SOUND READY
- DCC FITTED
- SPEAKER FITTED
- INTERIOR LIGHTS

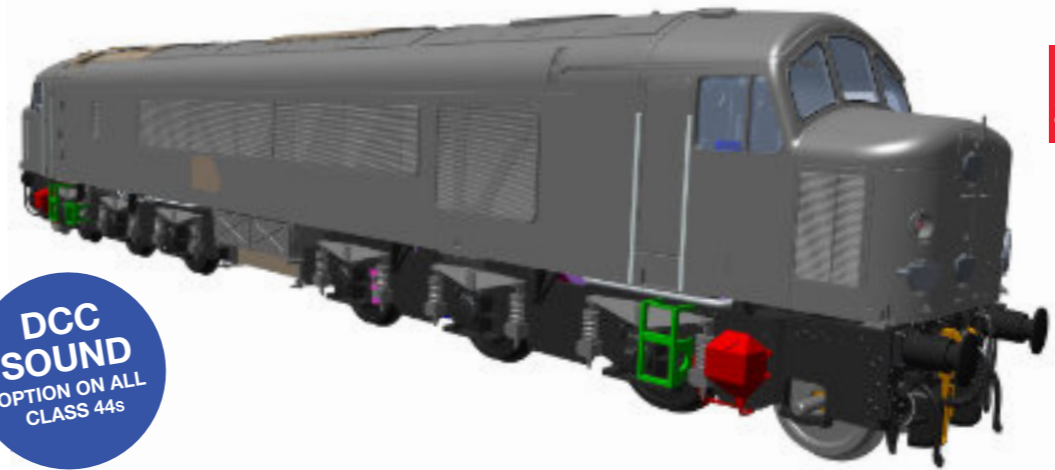

NEW FOR 2025!

DCC SOUND
OPTION ON ALL CLASS 44s

NEW! BR/SULZER TYPE 4 - CLASS 44

Class Profile: Delivered in 1959/60 as the largest and most powerful of BR's 'Pilot Scheme' diesel locomotives, the 2,300hp BR/Sulzer Class 44s were initially deployed on West Coast Main Line expresses. Quickly superseded by lighter and more powerful designs, the 10 locomotives were demoted to freight work in the Midlands, where they worked from the early-1960s until 1980. Our new model will be the first to cover all the major Class 44 variations, including the experimental slotted grilles carried by D9/D10. This outstanding new model will feature an all-new body tooling with bespoke bogie and underframe parts, detailed cab interiors and much more!

Built by: BR Derby Works
Number built: 10
Number series: D1-D10
Service Career: 1959-80
Region: London Midland
Purpose: Passenger/freight
Status in 2025: 2 preserved (44004/008)

NEW FOR 2025! BR CLASS 44

No.	Description
4400	BR Green D6 <i>Whernside</i> DCC READY
44003	BR Green D6 <i>Whernside</i> DCC SOUND
4401	BR Green D9 <i>Snowdon</i> (Small Yellow Panels) DCC READY
44013	BR Green D9 <i>Snowdon</i> (Small Yellow Panels) DCC SOUND
4402	BR Blue 1 <i>Scafell Pike</i> DCC READY
44023	BR Blue 1 <i>Scafell Pike</i> DCC SOUND
4403	BR Economy Green D5 <i>Cross Fell</i> DCC READY
44033	BR Economy Green D5 <i>Cross Fell</i> DCC SOUND
4404	BR Blue 44010 <i>Tryfan</i> DCC READY
44043	BR Blue 44010 <i>Tryfan</i> DCC SOUND
4406	BR Blue 44002 <i>Helvellyn</i> DCC READY
44063	BR Blue 44002 <i>Helvellyn</i> DCC SOUND

info

- 21 PIN
- DCC READY
- NEM COUPLERS
- WORKING LIGHTS
- SPRUNG BUFFERS
- SPEAKER FITTED
- DCC FITTED
- SOUND FITTED
- INTERIOR LIGHTS

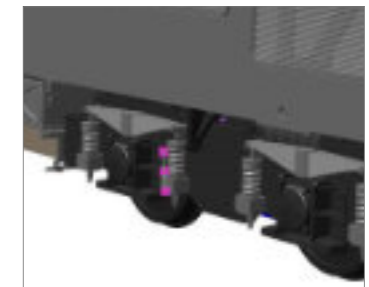



info

BR/SULZER TYPE 4 - CLASS 45

Class Profile: This heavyweight Type 4 proved its worth hauling everything from named expresses to unfitted mineral trains. Closely associated with the Midland Main Line and cross-country routes, the class could be seen over a wide area from central Scotland to the west of Cornwall. A huge range of detail variations has been designed into the model, allowing accurate depictions of specific Class 45/0s and 45/1s for the first time. Following the incredible reaction to the initial batch of '45s', a second production run is now available in a range of new liveries.

Built by: BR Derby Works
Number built: 127
Number series: D11-D137
Service Career: 1961 onwards
Region: All except Southern
Purpose: Passenger/mixed traffic
Status in 2025: 11 preserved

AVAILABLE NOW! BR DERBY/SULZER CLASS 45 VERSION 1 - EARLY CLASS 45/0 WITH SPLIT-CENTRE HEADCODE

No.	Description
45102	BR Economy Green D63 <i>Royal Inniskilling Fusilier</i> (small yellow panel)
45103	BR Blue D50 <i>The King's Shropshire Light Infantry</i> (small yellow panel)
45105	BR Blue 45032 (domino headcodes)

VERSION 3 - CLASS 45/0 WITH SEALED BEAM ENDS

45301	BR Blue 45055 <i>Royal Corps of Transport</i> (red bufferbeams)
45303	BR Blue 97409 'Lytham St Annes' (Tinsley painted names) WEATHERED

VERSION 4 - CLASS 45/1 WITH SEALED BEAM ENDS

45400	BR Blue 45144 <i>Royal Signals</i>
45401	BR Blue 45110 (white body stripe)

VERSION 5 - CLASS 45/1 WITH SEALED BEAM ENDS AND HI HEADLIGHT (1986-88)

45504	BR Blue 45104 <i>The Royal Warwickshire Fusiliers</i> (orange cantrail stripe, black bonnet/cab)
-------	--



TEAM HELJAN 2025 UK TOUR DATES!

FEBRUARY 21-23

MODEL RAIL SCOTLAND, SEC GLASGOW

APRIL 26-27

MODEL WORLD LIVE, NEC BIRMINGHAM

SEPTEMBER 6-7

GUILDEX 2025, STAFFORDSHIRE SHOWGROUND

OCTOBER 25-26

MIOG 2025, CREWE HERITAGE CENTRE

LOOK OUT FOR MORE SHOW INFORMATION ON OUR [FACEBOOK PAGE](#)



DCC SOUND
 AVAILABLE ON ALL CLASS 47s

BRUSH TYPE 4 - CLASS 47

Class Profile: An all-new OO gauge version of BR's most numerous main line diesel type. Employed on every type of train, they were built from 1962-67 to provide BR with a more powerful Type 4 diesel-electric that was also lighter and more versatile than its predecessors. Our new model is designed to depict a huge range of detail variations across the class, including different boiler roof panels, radiator grilles, cab front designs, underframe tanks and lighting arrangements. A rolling programme of releases over the coming years will cover all major liveries, periods and subclasses with close attention to detail differences.

PLEASE NOTE - All Class 47s are available with a factory fitted ESU LOKSOUND V5 DECODER and bespoke Class 47/0 or 47/4 sound projects developed by renowned DCC sound specialist Legomanbiffo. Sound-fitted models have a '3' suffix on the item code, so #4710 with sound is #47103. Click the info button (left) for more information.

Built by: Brush Traction, Loughborough/BR Crewe Works
Number built: 512
Number series: D1500-D1999, D1100-11
Service Career: 1962 onwards
Region: All
Purpose: Mixed traffic
Status in 2025: 30 Active/32 preserved

AVAILABLE NOW! BRUSH TYPE 4 - CLASS 47

No.	Description
4710/47103	BR Two-Tone Green D1526 (Small Yellow Panels)
4711/47113	BR Two-Tone Green D1969 (Full Yellow Ends)
4712/47123	BR Blue 47137 (glazed headcode panel)
4720/47203	BR Blue 47316 (plated headcode panels)
4721/47213	BR Large Logo Blue 47450
4722/47223	Railfreight 'Red Stripe' Grey 47214 <i>Tinsley Traction Depot</i>
4723/47233	Railfreight Petroleum 47125 <i>Tonnidae</i>
4724/47243	InterCity Executive 47555 <i>The Commonwealth Spirit</i>
4725/47253	Departmental General Grey 47329
4726/47263	Parcels Red/Grey 47575 <i>City of Hereford</i>



PREMIUM FEATURES. DELIVERED AS STANDARD

Our most sophisticated and customisable 'OO' locomotive to date will feature a huge range of detail options and desirable features to suit the most demanding of modellers.



Standard Features include...

- Independently switched HI headlights, cab, tail and engine room lights
 - Twin speakers on DCC Sound models
 - Bespoke Legomanbiffo sound projects tailored to match steam/no heat and ETH locos
 - 30 DCC Sound and Lighting Functions!
 - 5-pole motor with twin flywheels for smooth and powerful operation
 - Nine boiler roof panel options (Stones/ Spanner/Clayton and plated options)
 - Original or Serck radiator shutters
 - 12+ cab front arrangements with more planned
 - Original, plated headcode, crash repair and cutaway bufferbeam ends
 - With/without boiler water tanks and extended range fuel tank options
 - Superb bogie and underframe detail
 - Fine etched brass footsteps and lamp irons
 - Cab front or bufferbeam-mounted ETH equipment
 - Optional three-piece miniature snowploughs
- And much more!



BRUSH CLASS 57

Class Profile: Between 1998 and 2004, 33 Class 47s were re-engineered with General Motors EMD 645-series engines and Class 56 alternators. A first batch for Freightliner was followed by a passenger prototype (Porterbrook 57601) and rescue/passenger locomotives for Virgin West Coast and First Great Western. Over the last two decades, the fleet has been more widely distributed with operators including Advenza Freight, DRS, Network Rail, Locomotive Services Ltd, Rail Operations Group and West Coast Railways. This new batch of models features an upgraded chassis with LED lighting and a 21-pin DCC decoder interface.

Rebuilt by: Brush Traction, Loughborough
Number rebuilt: 33
Number series: 57001-012, 57301-316, 57601-605
Service Career: 1998 onwards
Region: All
Purpose: Mixed traffic
Status in 2025: Active

21 PIN

DCC READY

NEM COUPLERS

WORKING LIGHTS

SPRUNG BUFFERS

SOUND READY

FIT INTERIOR LIGHTS

info



GWR AEC DIESEL RAILCARS

Class Profile: The GWR pioneered the use of diesel railcars for passenger traffic in the 1930s. The most numerous variant was the batch built in 1940-42 with its distinctive angular 'razor edge' bodywork. Employed on branch lines and local services, they were the perfect single vehicle passenger train and continued to provide sterling service until replaced by BR DMUs in the early-1960s. This model features no fewer than nine separately switchable lighting functions and fully detailed interiors.

AVAILABLE NOW! GWR AEC PARCELS RAILCAR

No.	Description
19430	GWR Chocolate/Cream No.34 with coat of arms (dark grey roof)
19431	BR 'Express Parcels' Crimson No. 34 (grey roof)
19432	BR 'Express Parcels' Crimson No. 34 (grey roof) WEATHERED

AVAILABLE NOW! GWR AEC PASSENGER RAILCARS

19401	GWR Chocolate/Cream with monogram (grey roof)*
-------	--

AVAILABLE NOW! BRUSH TRACTION CLASS 57

No.	Description
5706	Virgin Trains 57302 <i>Virgil Tracy</i> WEATHERED
5707	Virgin Trains 57309 <i>Brains</i>
5708	First Great Western 'Fag Packet' Green 57603 <i>Tintagel Castle</i>
5710	GWR Green 57605 <i>Totnes Castle</i>
5711	GWR Lined Green 57604 <i>Pendennis Castle</i>
5712	West Coast Railways 'Northern Belle' 57601 <i>Windsor Castle</i>
5713	Network Rail Yellow 57312
5714	LSL Lined Black 57311

Built by: AEC/GWR Swindon Works

Number built: 14 + 1

Number series: 19-33, 34

Service Career: 1940-62

Region: GWR/BR Western Region

Purpose: Local and branch line passenger/parcels

Status in 2025: 2 preserved (Nos. 19/22)

Features: Nine lighting functions, all-wheel drive, low-profile motor, full interior detail

19406	GWR Chocolate/Cream No. 23 with monogram (white roof)*
19407	BR Crimson/Cream W20W (grey roof) WEATHERED*
19408	GWR Chocolate/Cream No.22 with monogram (grey roof)*
19409	BR Green with speed whiskers W26W (grey roof)*

21 PIN

DCC READY

NEM COUPLERS

WORKING LIGHTS

SPRUNG BUFFERS

SOUND READY

FIT INTERIOR LIGHTS

info



WAGGON & MASCHINENBAU DIESEL RAILBUS

Class Profile: Inspired by their widespread and successful use on rural lines in Germany, BR tested a series of lightweight railbus designs from the late-1950s. Most were built by British coachbuilders, but five vehicles for the Eastern Region were imported from Germany. Although largely successful in increasing passenger traffic, the railbuses were often unreliable and were made redundant when many of the lines they operated were closed during the Beeching cuts of the 1960s.

Built by: Waggon u. Maschinenbau, Donaueschingen, Germany
Number built: 5
Service Career: 1958-67
Region: Eastern
Purpose: Branch line passenger
Status in 2025: 4 preserved (79960/962-964)

AVAILABLE NOW! W&M Diesel Railbus

No.	Description
8707	BR Green E79963 (speed whiskers)
8708	BR Green E79961 (larger yellow panels)
8709	BR Green E79964 (speed whiskers) WEATHERED
8711	BR Green E79960 (small yellow panels) WEATHERED
8712	Railway Technical Centre red/blue 'Laboratory 20'
8713	Worth Valley red/grey/black No. 64
8714	BR Brown/Yellow Track Recording Car DB999507

21 PIN

DCC READY

WORKING LIGHTS

SPRUNG BUFFERS

FIT INTERIOR LIGHTS

info



DUE EARLY 2025!

BRCW CLASS 104 DMU

Class Profile: One of the most numerous designs of diesel railcar introduced by BR in the second half of the 1950s. Delivered to the LMR in the north-west of England and the North Eastern Region in Yorkshire and the north-east of England, they were used on a wide range of duties, most famously to Buxton and Blackpool. In later years, a few sets migrated to East Anglia, Scotland and London. Our models depict standard LMR three-car and NER/ER two-car 'power-trailer' sets and later two-car 'power twin' sets. Among the many neatly designed features, discreet inter-car connections allow lighting and sound functions to be controlled by one decoder. All DMBS/DMCL vehicles have factory-fitted speakers.

Built by: Birmingham Railway Carriage & Wagon Co., Smethwick
Number built: 302 vehicles
Formations: 2/3/4-car
Service Career: 1957-93
Region: London Midland/North Eastern/Eastern/Scottish
Purpose: Secondary/Regional passenger
Status in 2025: 13 vehicles preserved
Features: Factory fitted speakers, electrical connection between cars, magnetic couplers, full interior detail

DUE EARLY-2025! BRCW CLASS 104 DMU

No.	Proposed Liveries
1450	BR Early Green with Lion & Wheel emblem M50422+M59134+M50426
1451	BR Green with speed whiskers & Coaching Stock roundel M50478+M59186+M50530
1452	BR Green E50598+E56189 (Small Yellow Warning Panels)
1453	BR Blue 3-car M50436+M59141+M50488 (full yellow ends/headcode panel)
1454	BR Blue with 'Blackpool' white stripe M50472+M59180+M50524
1455	BR Blue M53421+M53529 with NSE flash/white cab roof WEATHERED
1456	ScotRail 'Mexican Bean' Red/White SC53424+SC53434
1457	BR Blue/Grey 'BX487' M53424+M59207+M53434
1458	Revised Network SouthEast 'L701' 53437+53479

21 PIN

DCC READY

NEM COUPLERS

WORKING LIGHTS

SPRUNG BUFFERS

SPEAKER FITTED

FIT INTERIOR LIGHTS

info



BR 'AL6' - CLASS 86/0

Class Profile: BR's standard 25kV AC electric locomotive of the late-1960s, developed using experience gained with the earlier 'AL1' to 'AL5' classes. Deployed on many duties from 100mph express passenger trains to fast freight, parcels and mail traffic, a handful of '86s' remain in use today both in the UK and overseas. This variant looks back at the as-built 'AL6' machines and Class 86/0s of the 1965-80 period and features a number of improvements over our previous Class 86s.

Built by: BR Doncaster Works/Vulcan Foundry
Number built: 100
Number series: E3100-99, 86001-048
Service Career: 1965 onwards
Region: London Midland/Scottish
Purpose: Mixed traffic
Status in 2025: All rebuilt to various sub-classes (see below)

AVAILABLE NOW! BR 'AL6' - CLASS 86/0 (1965-80)

No.	Description
8652	BR Blue E3178 (Full Yellow Ends)
8653	BR Rail Blue E3146 with white cab roof (Full Yellow Ends)
8654	BR Rail Blue E3134 (Full Yellow Ends)
8656	BR Rail Blue 86034 (Full Yellow Ends) WEATHERED
8657	BR Blue E3156
8658	BR Blue E3101 (Small Yellow Panels/Red buffer-beams)
8659	BR Rail Blue 86011 (orange cantrail line)



NEW
VERSION
FOR
2025!

BR CLASS 86/2

Class Profile: BR's standard 25kV AC electric locomotive of the late-1960s, developed using experience gained with the earlier 'AL1' to 'AL5' classes. A handful of '86s' remain in use today both in the UK and overseas. This latest variant features a number of improvements over our previous Class 86s, including separately switchable tail lights in DCC mode. It focuses on the popular Class 86/2 used for 100/110mph express passenger and parcels duties from the mid-1970s until the 2000s. Models are supplied with either a Faveley or Brecknell Willis high-speed pantograph. See p19 for replacement pantographs.

Built by: BR Doncaster Works/Vulcan Foundry
Number built: 100 (57 modified as Class 86/2)
Number series: 86204-261
Service Career: 1973 onwards
Region: London Midland/Eastern/Scottish
Purpose: Express passenger/parcels
Status in 2025: 1 active in UK, plus others exported to Hungary and Bulgaria

NEW VERSION DUE 2025!

BR CLASS 86/2 - LATE-1970s ONWARDS

No.	Description
8621	BR Rail Blue 86253 <i>The Manchester Guardian</i> *
8623	InterCity Executive 86204 <i>City of Carlisle</i> *
8630	InterCity Swift 86238 <i>European Community</i> *
8631	Virgin Trains 86240 <i>Bishop Eric Treacy</i> +
8633	Electric Blue 86259 <i>Les Ross</i> *
8634	EWS Red/Gold 86261 <i>Rail Charter Partnership</i> *
8635	Colas Railfreight 86701 <i>Orion</i> +
8636	Anglia Railways 86260*

*Faveley pantograph + Brecknell Willis pantograph



BR CLASS 86/4

Class Profile: BR's standard 25kV AC electric locomotive of the late-1960s, developed using experience gained with the earlier 'AL1' to 'AL5' classes. A handful of '86s' remain in use today both in the UK and overseas. This popular variant features a number of improvements over our previous Class 86s, including separately switchable tail lights in DCC mode. It focuses on the mixed traffic '86/4' and freight-only '86/6' sub-classes modified from the mid-1980s onwards. Models are supplied with either a Faveley (*) or Brecknell Willis high-speed (+) pantograph.

Built by: BR Doncaster Works/Vulcan Foundry
Number built: 100 (39 modified to Class 86/4)
Number series: 86401-439
Service Career: 1985 onwards
Region: London Midland/Eastern/Scottish
Purpose: Mixed traffic/freight
Status in 2025: 1 active in UK, plus others exported to Hungary and Bulgaria

AVAILABLE NOW! BR CLASS 86/4 & 86/6

No.	Description
8641	Railfreight Distribution Grey 86634 <i>University of London</i> *
8642	Rail express systems Red/Grey 86416*
8643	BR 'retro' Blue 86426/E3195*
8644	Railfreight Distribution European Grey 86622*
8645	Caledonian Sleeper 86401 <i>Mons Meg</i> +
8646	Freightliner Green/Yellow 86609*
8649	BR Blue 86402
8661	InterCity Mainline 86417 <i>The Kingsman</i> *
1985-0012	Replacement Faveley Pantograph x1
1985-0013	Replacement Brecknell Willis High Speed Pantograph x1



BR NEWTON CHAMBERS CAR TRANSPORTER

Service Career: 1961-88
Region: Eastern/Scottish/Western
Purpose: Motorail
BR TOPS code: TCV/NVV/NVX
Use with: BR Class 27/45/47/52/55/86/DP2, ex-LNER 'Pacific' steam locomotives
Status in 2025: Extinct
Features: Early/late rooflight arrangement, steam/dual heating parts, vacuum/dual braking parts, fine bogie/underframe detail, weathered option, authentic livery differences between vehicles in each pack.

LAST FEW! NEWTON CHAMBERS CAR TRANSPORTER

No.	Description
9622	BR Lined Maroon Pack 1: E96287/291/294E WEATHERED
9625	BR Blue/Grey Pack 3: NVV E96288/289/293E WEATHERED
9630	BR Motorail Blue/Grey (Early) TCV E96297E
9631	BR Motorail Blue/Grey (Early) TCV E96298E
9632	BR Motorail Blue/Grey (Late) NVX E96291E
9633	BR Motorail Blue/Grey (Late) NVX E96294E
9634	BR Motorail Blue/Grey (Late) NVX E96299E
1985-0017	10x Super Strong Magnetic Couplers - suitable for all locomotives/rolling stock with compatible NEM coupler boxes.

21 PIN

DCC READY

NEM COUPLERS

WORKING LIGHTS

SPRUNG BUFFERS

SOUND READY

SOUND READY

21 PIN

DCC READY

NEM COUPLERS

WORKING LIGHTS

SPRUNG BUFFERS

SOUND READY

info

21 PIN

DCC READY

NEM COUPLERS

WORKING LIGHTS

SPRUNG BUFFERS

SOUND READY

SOUND READY

info



NEW FOR 2025!

O Gauge Pre-production sample shown above.

DCC READY

21 PIN

SPEAKER FITTED

NEM COUPLERS

WORKING LIGHTS

INTERIOR LIGHTS

info

BR CLASS 153 RAILCAR

Class Profile: Class 153s have been a familiar part of the railway scene for more than 30 years. Reaching almost every corner of the network, from Penzance to the Highlands of Scotland, they are one of the few 'go anywhere' trains and the perfect single vehicle train for any layout. This outstanding new 'OO' model will feature a wealth of authentic details, eight separately switchable lighting functions, day/night headlights and interior lights. Other standard features include factory fitted speakers, magnetic BSI couplers, obstacle deflectors and a superb interior. All models are offered DCC Ready or with factory fitted DCC and sound.

Built by: Leyland Bus, Workington
Number built: 70
Number series: 153301-335/351-385
Service Career: 1991 onwards
Region: All
Purpose: Regional/Local Passenger
Status in 2025: 39 active/1 Preserved

DCC SOUND
OPTION ON ALL CLASS 153s

NEW FOR 2025! BR CLASS 153 RAILCAR

No.	Description
5360	Regional Railways 153301 DCC READY
53603	Regional Railways 153301 DCC SOUND
5364	Stagecoach East Midlands Trains 153311 DCC READY
53643	Stagecoach East Midlands Trains 153311 DCC SOUND
5365	Northern 'Swoosh' 153351 DCC READY
53653	Northern 'Swoosh' 153351 DCC SOUND
5367	Transport for Wales Grey/Red 153906 DCC READY
53673	Transport for Wales Grey/Red 153906 DCC SOUND
5369	London Midland City 153356 DCC READY
53693	London Midland City 153356 DCC SOUND



NEW FOR 2025!

DCC SOUND
OPTION ON ALL CLASS 155s

DCC READY

21 PIN

SPEAKER FITTED

NEM COUPLERS

WORKING LIGHTS

INTERIOR LIGHTS

info

BR CLASS 155 DMU

Class Profile: Continuing our Leyland 'Super Sprinter' theme for 2025 is the much-requested Class 155 DMU. Delivered to Provincial Services in 1988, 35 of these units were quickly rebuilt as Class 153s (see above). However, seven sets built for West Yorkshire PTE remain in use with Northern. Our outstanding new 'OO' model will feature eight separately switchable lighting functions, day/night headlights and interior lights. Other standard features include factory fitted speakers, magnetic BSI couplers, obstacle deflectors and superb interiors. All models are offered DCC Ready or with factory fitted DCC and sound.

Built by: Leyland Bus, Workington
Number built: 42
Number series: 155301-342
Service Career: 1988 onwards
Region: Western/Southern/Yorkshire
Purpose: Regional passenger
Status in 2025: 7 sets active with Northern

NEW FOR 2025! BR CLASS 155 2-CAR DMU

No.	Description
5590	Provincial 'Sprinter' 155301 DCC READY
55903	Provincial 'Sprinter' 155301 DCC SOUND
5591	Provincial 'Sprinter' 155324 DCC READY
55913	Provincial 'Sprinter' 155324 DCC SOUND
5592	West Yorkshire PTE Red/Cream/Yellow 155344 DCC READY
55923	West Yorkshire PTE Red/Cream/Yellow 155344 DCC SOUND
5593	West Yorkshire PTE Revised Red/Cream 155345 DCC READY
55933	West Yorkshire PTE Revised Red/Cream 155345 DCC SOUND
5594	Northern 155346 DCC READY
55943	Northern 155346 DCC SOUND

'OO' WAGONS



DUE EARLY 2025!

SPRUNG BUFFERS

NEM COUPLERS

info

35T 'A TANK'

Vehicle Profile: Our ever-popular 35T 'Class A' (light fuel) tank wagons are back and available in a range of attractive packs featuring all the most popular liveries from the 1950s through to the 1980s. Presented in packs of four wagons with new running numbers and individual decoration they're an ideal way to build up authentic block trains quickly and economically. All models feature sprung metal buffers, free-running wheelsets with pinpoint axles and NEM couplings as well as exquisite walkway and ladder detail and superb decoration.

Service Career: 1950s-1980s
Region: All
Purpose: Fuel oil/diesel transport
BR TOPS code: Various
Use with: BR Steam and Diesel Locomotives

DUE EARLY-2025! 35 TON 'A TANKS'

No.	Description
1155	ESSO Silver/Red (Full Branding) 3200/3201/3202/3203
1156	ESSO Grey/Red 4022/4088/4305/4306
1157	ESSO Grey/Red (Hazchem Panels) 43297/44101/44125/44292



DUE EARLY 2025!

SPRUNG BUFFERS

NEM COUPLERS

info

35T 'B TANK'

Class Profile: Made famous by the old Airfix kit, these popular 'Class B' (heavy oil) wagons were an early type of high-capacity tank wagon for bulk oil operations from the late-1950s. Presented in packs of four wagons (except ICI) with new running numbers and individual decoration they're an ideal way to build up authentic block trains quickly and economically. All models feature sprung metal buffers, free-running wheelsets with pinpoint axles and NEM couplings as well as exquisite walkway and ladder detail and superb decoration.

Service Career: 1950s-1990s
Region: All
Purpose: Fuel oil/diesel transport
BR TOPS code: Various
Use with: BR Steam and Diesel Locomotives

DUE EARLY-2025! 35 TON 'B TANKS'

No.	Description
1112	ESSO Black (Full Branding) 3301/3303/3329/3331
1113	ESSO Black (Logo only) 3555/3556/3575/3578
1114	REGENT OIL Black 370/375/404/441
1115	FINA Black 200/209/236/237
1116	Molasses Grey TSV 48559/591/617/623 (1980s)
1117	ICI Blue/Orange No. 384 (solo wagon)



CARGOWAGGON IWB BOGIE VAN

Number Built: 120
Service Career: 1979-80 onwards
Region: All
Purpose: International palletised merchandise/barrier wagons for new rolling stock
BR TOPS code: IWB
Use with: BR Class 25/26/27/33/45/47/86

AVAILABLE NOW! CARGOWAGGON IWB BOGIE VAN

No.	Description
5023	Colas/Tarmac Grey
5024	Blue Circle Cement Yellow
5025	Blue Circle Cement Yellow WEATHERED
5026	Silver/Blue
5029	CARGOWAGGON Silver/Blue WEATHERED



CARGOWAGGON IGA BOGIE FLAT

Service Career: 1979 onwards
Region: All
Purpose: International merchandise traffic
BR TOPS code: IGA/IGB
Use with: BR Class 25/26/27/33/45/47/86

AVAILABLE NOW! CARGOWAGGON IGA BOGIE FLAT

No.	Description
5105	Corus Rail Blue
5109	CARGOWAGGON Blue
5110	CARGOWAGGON Blue (alt number)
5111	CARGOWAGGON Blue WEATHERED
5112	CARGOWAGGON Blue (with pipe load)
5113	CARGOWAGGON Blue (with pipe load) WEATHERED
5114	CARGOWAGGON Blue (with timber load) WEATHERED
5115	RailAdventure Grey barrier wagons with concrete panel load* TWIN PACK

*Twin pack #5115 (shown below) is intended for use with barrier/translator vans #5020, both types being used in connection with the delivery of new trains to Britain via the Channel Tunnel.



O GAUGE

LOCOMOTIVES AND ROLLING STOCK



'O' GAUGE LOCOMOTIVES

DUE
EARLY
202521
PIN

GWR AEC DIESEL RAILCAR

Class Profile: The GWR pioneered the use of diesel railcars in the 1930s but the most numerous variant was built in 1940-42 with distinctive 'razor edge' bodywork. Employed on branch lines and local services, they were the perfect single vehicle train and continued to provide sterling service until replaced by BR DMUs in the early-1960s.

Built by: AEC/GWR Swindon Works

Number built: 14

Number series: 19-33

Service Career: 1940-62

Region: GWR/BR Western Region

Purpose: Local and branch line passenger

Status in 2025: 2 preserved (Nos. 19/22)

AVAILABLE NOW! GWR AEC DIESEL RAILCAR

No.	Description
1902	BR Crimson/Cream W20W (dark grey roof)
1903	BR Crimson/Cream W21W (white cab roofs)
1904	BR Green with speed whiskers W32W (white cab roofs)
1905	BR Green with speed whiskers W26W (dark grey roof)

DCC
READYNEXT
18SPEAKER
FITTEDSOUND
READYWORKING
LIGHTS

RUSTON & HORNSBY 48DS

Class Profile: Perfect for layouts of every size, our tiny Ruston 48DS diesel depicts one of the smallest standard gauge locomotives ever to run on British rails. Designed from scratch using original research and drawings provided by Ruston 48DS experts, this superb new entry-level model is a must have for modellers of the industrial scene, BR era main line layouts and preservation sites. Delivering fine detail and a high specification at a budget price, including working headlamps and a fully detailed cab interior, it's a perfect starter model for 'O' gauge. Authentic detail variations include open cab and the later enclosed design, standard or deep bufferbeams and optional lifting rings.

Built by: Ruston & Hornsby, Lincoln

Number built: 237

Service Career: 1932 to 2010s

Region: All

Purpose: Light shunting

Status in 2025: Approx 40 preserved

AVAILABLE NOW! RUSTON & HORNSBY 48DS

No.	Description
9030	Ruston & Hornsby Factory Lined Green (Open Cab)
9032	Yellow/Wasp Stripes (Enclosed Cab)
9035	BR Southern Region Green DS1169 (Open Cab)
9037	Dark Green 'Sir William McAlpine' (Enclosed Cab)
9038	Express Dairy Blue (Open Cab)

info

21
PIN

BR/YORKSHIRE 0-4-ODH - CLASS 02

Class Profile: Built to replace the legendary Lyr 0-4-OST 'Pugs', this class of 20 short-wheelbase 0-4-0 diesel-hydraulic locomotives was based on a standard industrial design. Delivered to depots in the north-west of England for shunting tightly-curved lines around docks and goods depots, many were sold into industry in the late-1960s and subsequently preserved to enjoy a third life at heritage railways. Our outstanding new model features switchable cab lighting, smooth flywheel drive and a factory fitted speaker.

Built by: Yorkshire Engine Co., Sheffield

Number built: 20 (BR), 50 (industrial)

Number series: D2850-69

Service Career: 1960-75 (BR), late-1950s to 1990s (industrial)

Region: London Midland/ industrial

Purpose: Light shunting on tightly curved docks/industrial sites

Status in 2025: Seven preserved (D2853/54/58/60/66-68)

info

DUE EARLY-2025! YORKSHIRE ENGINE CO. 0-4-ODH

No.	Description
2870	BR Green (wasp stripes) unnumbered
2871	BR Green (wasp stripes) D2860
2872	BR Green 02004 (no BR logo) WEATHERED
2873	BR Blue 02005
2874	Redland Khaki 'Diane'
2875	Arnott & Young Yellow AY1021
2876	National Coal Board Pale Blue No. ND3
2877	Industrial Green 'SAM' WEATHERED/FADED

DCC
READYWORKING
LIGHTSSOUND
READYSPEAKER
FITTEDWORKING
LIGHTS

BR/EE TYPE 1 - CLASS 20

Class Profile: Probably the most successful of the BR 'Pilot Scheme' designs of the late-1950s, the '20s' have given almost seven decades of sterling service and a small number are still earning a living on the network today. Built for lighter goods work, including cross-London trip freights, they also proved to be extremely useful for heavier traffic when used in pairs. Reliable, robust and widely used - a true classic.

Built by: English Electric, Vulcan Foundry

Number built: 228

Number series: D8000-199, D8300-27

Service Career: 1957 onwards

Region: All except Western

Purpose: Freight

Status in 2025: 6 Active/22 preserved

info

AVAILABLE NOW! EE TYPE 1 / BR CLASS 20

No.	Description
2000	BR Green Unnumbered (small yellow panel)^
2001	BR Blue Unnumbered (full yellow ends)^
2003	BR Tinsley Railtour Green Unnumbered^
2004	BR Blue 20042 (DCE cabside stripes) WEATHERED *
2005	BR Green 20023 (full yellow ends) WEATHERED *
2013	BR Blue Unnumbered (domino headcodes)+
2016	BR Thornaby Blue/Red/White Unnumbered+
2017	BR Green D8132 (small yellow panels)+

*Disc headcodes +Centre headcode panels

DUE
MID
2025DCC
READYXL
PINSOUND
READYWORKING
LIGHTSINTERIOR
LIGHTSSPRUNG
BUFFERSSMOKE
READY

NEW! BR/SULZER CLASS 24

Class Profile: In recent years we've received more requests for an 'O' gauge Class 24 than anything else, so we've gone 'all out' to bring you not just a Class 24/0, but also the later Class 24/1s and Scottish Region '24/1s' with tablet catching equipment and twin headlights. The 'skinhead' Class 24s will arrive first in mid-2025, in six authentic BR era liveries. The Class 24/1s with headcode boxes will follow later in 2025. These outstanding new models will feature all-new body toolings with authentic variations between the different sub-types, bespoke bogie and underframe parts, detailed cab interiors and much more! 'Under the bonnet', all models will have a plug-and-play DCC interface, heavy duty twin motor/flywheel drive, authentic lighting functions and much more!

info

Built by: BR Derby/Darlington Works
Number built: 151
Number series: D5000-113 (Class 24/0), D5114-50 (Class 24/1), 24001-047/051-141
Service Career: 1958-80
Region: All except Western Region
Purpose: Mixed traffic
Status in 2025: 4 preserved (24032/054/061/081)

NEW FOR 2025! BR CLASS 24

No.	Description
2450	BR Green Unnumbered
2451	BR Green Unnumbered (Small Yellow Panels)
2452	BR Two-Tone Green D5072 (Small Yellow Panels)
2453	BR Blue Unnumbered (Full Yellow Ends)
2454	BR Green 24090 (Full Yellow Ends) WEATHERED
2455	BR Railway Technical Centre Red/Blue 97201

BR CLASS 24/1

No.	Description
2470	BR Green Unnumbered
2471	BR Green Unnumbered NER (Small Yellow Panels)
2472	BR Green Unnumbered ScR (Small Yellow Panels)
2473	BR Blue Unnumbered LMR (Full Yellow Ends)
2474	BR Blue Unnumbered ScR (Full Yellow Ends) TWIN HEADLIGHTS

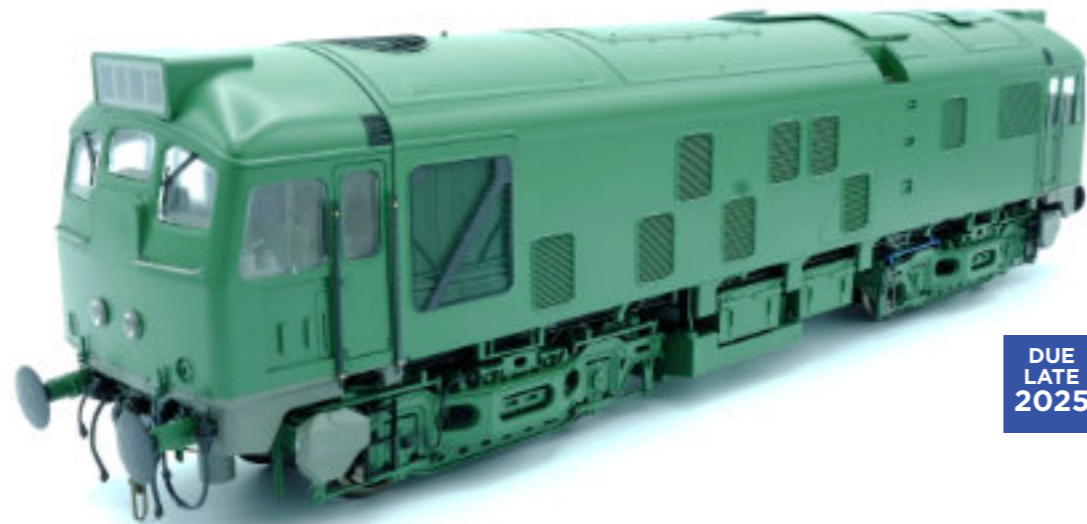
DUE
LATE
2025XL
PINDCC
READYSOUND
READYSPRUNG
BUFFERSINTERIOR
LIGHTSSMOKE
READYWORKING
LIGHTS

info

BRCW TYPE 2 - CLASS 26/1

Class Profile: One of the most successful and long-lived BR 'Pilot Scheme' designs; the initial 20 locomotives were followed by 26 more (Class 26/1) and all were concentrated on the Scottish Region from the early-1960s. These superb models offer 'plug-and-play' DCC capability, separately switched exterior, cab and engine room interior lighting, Far North Line twin car headlights, plus dual-braked locomotives with air tank cradle, two styles of radio pod, two designs of cab door and early models with a tablet catcher recess.

Built by: Birmingham Railway Carriage & Wagon Co.,
Number built: 26
Number series: D5320-46 (26021-046)
Service Career: 1959-93
Region: Scottish
Purpose: Mixed traffic
Status in 2025: 13 preserved (Class 26/0 - 26001/002/004/007/010/011/014, Class 26/1 - 26024/025/035/038/040/043)

AVAILABLE NOW! BRCW TYPE 2 - CLASS 26/1

No.	Description
2676	BR Green (Small Yellow Panels)
2677	BR Blue (Full Yellow Ends)
2678	BR Blue with Inverness twin headlights

REFURBISHED CLASS 26/1 (1983-93)

No.	Description
2682	BR Civil Engineers Grey/Yellow

XL
PINDCC
READYSOUND
READYSPRUNG
BUFFERSINTERIOR
LIGHTSSMOKE
READYWORKING
LIGHTS

info

BRCW TYPE 2 - CLASS 27

Class Profile: A more powerful development of Class 26 with a 1,250hp engine, GEC traction motors and four-character headcode panel. Initially distributed across the Midland, North Eastern and Scottish Regions, from the late-1960s they were concentrated in Scotland and continued in service until 1987. These superb models offer 'plug-and-play' DCC capability, two alternative designs of cab steps, boiler-fitted or non-boiler locomotives plus separately switched exterior, cab and engine room interior lighting.

Built by: Birmingham Railway Carriage & Wagon Co.,
Number built: 68
Number series: D5347-46 (27001-066, 27101-124)
Service Career: 1961-87
Region: LMR, North Eastern, Scottish
Purpose: Mixed traffic
Status in 2025: 8 preserved (27001/005/007/024/050/056/059/066)

AVAILABLE NOW! BRCW TYPE 2 - CLASS 27

No.	Description
2770	BR Green (Small Yellow Panel)
2771	BR Unlined Green 5370 (Full Yellow Ends) WEATHERED
2772	BR Green (Full Yellow Ends)
2773	BR Blue (Full Yellow Ends/Headcodes)
2775	BR Two-Tone Green D5382 (Small Yellow Panels)
2776	BR Blue D5389 (Small Yellow Panels)
2777	BR Blue 27032 (Inverness Stags) WEATHERED



DUE MID 2025



- XL PIN**
- DCC READY**
- SOUND READY**
- SPRUNG BUFFERS**
- INTERIOR LIGHTS**
- SMOKE READY**
- WORKING LIGHTS**

REFURBISHED BR CLASS 31

Class Profile: One of the great success stories from BR's 'Pilot Scheme' of the late-1950s. More than 60 years later these rugged and dependable Type 2s can still be seen on the national network and on heritage railways across the country. These refurbished Class 31/1s and 31/4s are suitable for the mid-1980s onwards working with a wide variety of freight, passenger and departmental stock. These models have been upgraded with our new XL 'plug-and-play' decoder interface for easy DCC conversion.

Built by: Brush Traction, Loughborough
Number built: 263
Number series: D5500-D5862
Service Career: Mid-1980s onwards (refurbished locos)
Region: Eastern/London Midland/Western
Purpose: Mixed traffic
Status in 2025: 1 Active/26 preserved

info

DUE MID-2025! REFURBISHED CLASS 31/1

No.	Description
3124	Railfreight Grey/Yellow Unnumbered
3126	Railfreight Coal Sector 31217

DUE MID-2025! CLASS 31/4 WITH HEADLIGHT

No.	Description
3146	BR Blue 31427
3147	BR Civil Engineers Grey/Yellow 31531

NEW VERSION!
WITH CUTAWAY BUFFERBEAMS



- XL PIN**
- DCC READY**
- SOUND READY**
- SPRUNG BUFFERS**
- INTERIOR LIGHTS**
- SMOKE READY**
- WORKING LIGHTS**

BR SPLIT HEADCODE CLASS 37/0

Class Profile: In response to customer demand, this latest variant of our O gauge Class 37/0 depicts the original 118 locomotives with split headcode panels and post-1970s cutaway bufferbeam cowlings. Our upgraded model features a number of improvements over earlier releases, including sharper detail, a plug-and-play DCC interface, switchable interior and exterior lighting and a wider choice of detail options. Models will be available with several nose end arrangements, with or without steam heating boiler ports, high-intensity headlights and with either cast or fabricated bogies according to livery and period.

Built by: English Electric Vulcan Foundry/RSH Darlington
Number built: 119
Number series: D6700-6818, 37001-119
Service Career: 1960 onwards
Region: All
Purpose: Mixed traffic
Status in 2025: 5 active/10 preserved

info

AVAILABLE NOW! CLASS 37/0 (SPLIT HEADCODE)

No.	Description
3720	BR Blue*
3721	BR Large Logo Blue*
3722	BR Civil Engineers grey/yellow +
3724	BR Green 37350/D6700 (full yellow ends) +
3725	Railfreight Sector grey (unbranded) +
3726	EWS Red/Gold +
3727	DRS Blue (early) +
3728	Railfreight 'Red Stripe' 37008 WEATHERED +

* Model with steam heating boiler + Model with HI headlight

NEW VERSION!
WITH CUTAWAY BUFFERBEAMS

DUE LATE 2025



- XL PIN**
- DCC READY**
- SOUND READY**
- SPRUNG BUFFERS**
- INTERIOR LIGHTS**
- SMOKE READY**
- WORKING LIGHTS**

BR CLASS 37/0 CENTRE HEADCODE

As a follow up to our acclaimed split headcode Class 37/0 released in 2024, this latest variant of our O gauge Class 37 family depicts the later locomotives with centre headcode panels and post-1970s cutaway bufferbeam cowlings. Our upgraded model features a number of improvements over earlier releases, including sharper detail, a plug-and-play DCC interface, switchable interior and exterior lighting and a wider choice of detail options. Models will be available with several nose end arrangements, with or without steam heating boiler ports, high-intensity headlights and with either cast or fabricated bogies according to livery and period.

Built by: English Electric Vulcan Foundry/RSH Darlington
Number built: 119
Number series: D6819-6999, D6600-08, 37120-308
Service Career: 1962 onwards
Region: All
Purpose: Mixed traffic
Status in 2025: 10 active/20 preserved

info

DUE 2025! CLASS 37/0 (CENTRE HEADCODE)

No.	Description
3730	BR Blue Unnumbered
3731	BR Large Logo Blue Unnumbered
3732	Railfreight Large Logo Grey 37196 <i>Tre Pol and Pen</i>
3733	Railfreight Sector 3T Grey Unbranded
3734	BR General Grey Unnumbered
3735	InterCity Swift 37152
3737	West Coast Railways Red 37248 <i>Loch Arkaig</i>
3738	Network Rail Yellow Class 97/3

DUE EARLY 2025



- XL PIN**
- DCC READY**
- SOUND READY**
- SPRUNG BUFFERS**
- INTERIOR LIGHTS**
- SMOKE READY**
- WORKING LIGHTS**

BR CLASS 45

Class Profile: This heavyweight Type 4 proved its worth over almost three decades hauling everything from named expresses to unfitted mineral trains. Closely associated with the Midland Main Line and cross-country routes, the class could be seen over a wide area from central Scotland to the far west of Cornwall. This new model builds on previous releases, featuring late-condition locomotives with sealed beam nose ends and Class 45/1s, modified with electric train heating (ETH) and HI headlights.

Built by: BR Derby Works
Number built: 127
Number series: 45001-077, 45101-150
Service Career: Mid-1970s to 1988
Region: All except Southern Region
Purpose: Mixed traffic
Status in 2025: 1 Active/11 preserved

info

DUE EARLY-2025! BR DERBY/SULZER TYPE 4 - CLASS 45 CLASS 45/0 WITH SEALED BEAM ENDS

No.	Description
4520	BR Blue Unnumbered
4521	BR Blue 45004 <i>Royal Irish Fusilier</i>
4522	BR Blue 45033 'Sirius' (Tinsley painted names) WEATHERED

ETH CLASS 45/1 WITH SEALED BEAM ENDS

No.	Description
4525	BR Blue Unnumbered
4526	BR Blue 45144 <i>Royal Signals</i>

ETH CLASS 45/1 WITH SEALED BEAM ENDS AND HIGH INTENSITY HEADLIGHT (1986-88)

No.	Description
4527	BR Blue Unnumbered
4528	BR Blue 45110 'Medusa' (Tinsley painted names)
4529	BR Railtour Green 45106 (full yellow ends)



BRUSH TYPE 4 - BR CLASS 47

Class Profile: A highly detailed model of this popular class, which was BR's most numerous main line diesel type. Employed on all kinds of trains from named expresses to unfitted mineral trains, they were built from 1961 onwards to provide BR with a more powerful Type 4 diesel-electric. This model depicts both 1960s/70s condition locomotives and 1980s to 2000s machines with later modifications.

Built by: Brush Traction, Loughborough/BR Crewe Works
Number built: 512
Number series: D1500-D1999, D1100-11
Service Career: 1962 onwards
Region: All
Purpose: Passenger/mixed traffic
Status in 2025: 44 active/32 preserved

LAST FEW IN STOCK! BR CLASS 47/0 & 47/4 (1980s-2000s)

No.	Description
4862	Railfreight 'Red Stripe' Grey Unnumbered
4863	Railfreight Three-Tone Grey Unbranded
4864	BR Civil Engineers Grey/Yellow Unnumbered
4866	InterCity Executive Class 47/4 Unnumbered
4867	Network SouthEast Class 47/4 Unnumbered

- DCC READY
- WORKING LIGHTS
- SPRUNG BUFFERS
- SOUND READY
- INTERIOR LIGHTS

info



BR CLASS 50

Class Profile: A class of 50 high-power Type 4 diesels built to accelerate Anglo-Scottish expresses during the electrification of the West Coast Main Line. Famously used in pairs prior to the start of electric services, the class was transferred to the Western Region in the mid-1970s to replace the 'Western' diesel-hydraulics. Our model depicts the class after refurbishment in the early-1980s.

Built by: English Electric, Vulcan Foundry
Number built: 50
Number series: D400-49, 50001-050
Service Career: 1967-93
Region: London Midland/Scottish (1967-76), Western/Southern (1974-93)
Purpose: Passenger/mixed traffic
Status in 2025: 4 active/18 preserved

LAST FEW IN STOCK! BR/EE CLASS 50

No.	Description
4021	BR Large Logo Blue (Grey Roof)
4029	BR Large Logo Blue (Black Roof)
4030	BR Large Logo Blue 50036 <i>Victorious</i> WEATHERED
4034	Hanson & Hall Grey 50008 <i>Thunderer</i>
4037	BR Large Logo Blue 50046 <i>Ajax</i> (Black Roof) WEATHERED
4038	Network SouthEast 50032 <i>Courageous</i> WEATHERED

- DCC READY
- WORKING LIGHTS
- SPRUNG BUFFERS
- SOUND READY
- INTERIOR LIGHTS

info



BR CLASS 55 'DELTAIC'

Class Profile: Developed from English Electric's astonishing 1955 prototype, the 22 production 'Deltics' used powerful but lightweight Napier gunboat engines to deliver a far greater power to weight ratio than any other diesel locomotive of their time. The result was a worthy successor to the legendary LNER Pacifics and their performances on the East Coast Main Line over a 20-year career made them equally iconic. Our fully retooled model can accommodate two large 'earth mover' speakers and two smoke units for that unforgettable 'Deltic' effect. Other new features include a plug-and-play DCC interface, interior detail and lighting and authentic detail variations for later period Class 55s.

Built by: English Electric, Vulcan Foundry
Number built: 22
Number series: D9000-21, 55001-022
Service Career: 1961-82
Region: Eastern/Scottish
Purpose: Express passenger
Status in 2025: 6 preserved (D9000/02/09/15/16/19)

- XL PIN
- DCC READY
- WORKING LIGHTS
- INTERIOR LIGHTS
- SPRUNG BUFFERS
- SOUND READY
- SMOKE READY

info

AVAILABLE NOW! EE/BR CLASS 55 1976-82

No.	Description
5520	BR Blue 55007 <i>Pinza</i>
5521	BR Blue unnumbered
5522	BR Blue 55015 <i>Tulyar</i> (white cabs)
5523	BR Blue unnumbered (white cabs)
5524	BR Green 55002 <i>King's Own Yorkshire Light Infantry</i> (full yellow ends)
5525	BR Railtour Blue 55022 <i>Royal Scots Grey</i>
5526	BR Blue 55011 <i>Royal Northumberland Fusiliers</i> WEATHERED

PRESERVED CLASS 55 WITH HI HEADLIGHT

No.	Description
5530	BR Green D9000 <i>Royal Scots Grey</i> (small yellow warning panel)
5531	BR Blue 55019 <i>Royal Highland Fusilier</i>
5532	BR Blue unnumbered (white cabs)



BR CLASS 56

Class Profile: The first of BR's heavy Type 5 freight diesels, introduced to cope with an increase in coal traffic after the 1973 oil crisis. The first 30 were built by Electroputere in Romania under sub-contract from Brush, while the rest were constructed by BREL at Doncaster (56031-115) and Crewe (56116-135). Although they were retired by EWS in 2003, a number have been reactivated for use by freight companies such as Colas, UK Rail Leasing and, soon, GB Railfreight. Our version is based on the later Doncaster and Crewe variant (56056-135).

Built by: BR Doncaster/Crewe Works
Number built: 135
Number series: 56001-135
Service Career: 1976 onwards
Region: All
Purpose: Heavy freight
Status in 2025: 13 active/3 preserved

- DCC READY
- WORKING LIGHTS
- SPRUNG BUFFERS
- SOUND READY
- INTERIOR LIGHTS
- SMOKE READY

info

AVAILABLE NOW! BR CLASS 56

No.	Description
5602	Railfreight Large Logo Grey
5603	Railfreight 'Red Stripe' Grey
5604	Railfreight Three-Tone Grey Unbranded
5605	Railfreight Coal Sector 56101 <i>Mutual Improvement</i> WEATHERED
5606	Railfreight Construction 56110 <i>Craft</i>
5607	Loadhaul Black/Orange





BR CLASS 58

Class Profile: Designed with an eye on the export market, the 50 Class 58s were the last diesel locomotives built by British Rail. For much of their life, they were employed shifting coal between Midlands collieries and power stations alongside the Class 56s. From the mid-1990s, their range of duties expanded and they were largely focused in the south-east of England for Mainline and later EWS. Our superb model covers both Phase 1 and Phase 2 locomotives with numerous detail differences, authentic lighting functions and a plug-and-play DCC decoder interface.

Built by: BR Doncaster Works
Number built: 50
Number series: 58001-050
Service Career: 1983 onwards
Region: All except Scottish Region
Purpose: Heavy freight
Status in 2025: 0 Active/2 preserved

AVAILABLE NOW! BR CLASS 58

No.	Description
5851	Railfreight Red Stripe Grey Unnumbered
5853	Railfreight Coal Sector Unnumbered
5854	EWS Red/Gold Unnumbered
5857	Mainline 3T Grey Unnumbered
5858	Railfreight Sector Grey Unnumbered/Unbranded

- XL PIN
- DCC READY
- WORKING LIGHTS
- SPRUNG BUFFERS
- SOUND READY
- SMOKE READY
- INTERIOR LIGHTS

info



BR CLASS 73/1 ELECTRO-DIESEL

Class Profile: In tribute to these amazing survivors, our most detailed and sophisticated model to date depicts the Class 73/1 production batch, many of which are still active today. Featuring more than 550 separate parts, authentic lighting functions, DCC-activated third-rail 'arc flash' and poseable collector shoes, the '73' sets a new benchmark for British 'O' gauge. The models are available in all the most popular liveries carried across their long career, with both fully numbered/named and unnumbered versions available.

Built by: English Electric Vulcan Foundry
Number built: 42
Number series: E6006-48, 73101-142, 73201-213
Service Career: 1965 onwards
Region: Southern
Purpose: Mixed traffic
Status in 2025: 13 active/6 preserved

AVAILABLE NOW! EE/BR CLASS 73/1

No.	Description
7300	BR Blue (early) E6008 (small yellow panels/ grey band)
7301	BR Blue E6020 (small yellow panels/ grey roof)
7302	BR Rail Blue 73137 (full yellow end) WEATHERED
7303	BR Large Logo Blue
7304	InterCity Executive
7305	BR 'Dutch' grey/yellow
7306	Network SouthEast 73126 <i>Kent & East Sussex Railway</i>
7308	EWS Red/Gold
7309	Network Rail Yellow 73212
7310	GB Railfreight Blue/Orange 73107 <i>Tracy</i>

- XL PIN
- DCC READY
- WORKING LIGHTS
- SPRUNG BUFFERS
- SOUND READY
- SMOKE READY
- INTERIOR LIGHTS

info

DUE SPRING 2025



DCC SOUND AVAILABLE ON ALL CLASS 153s



NEW! BR CLASS 153 DIESEL RAILCAR

Class Profile: Skateboard, Dogbox, Tin Rocket - call them what you like but Class 153s have been a familiar part of the UK railway scene for more than 30 years. Reaching almost every corner of the network, from Penzance to the Highlands of Scotland and Fishguard to Lowestoft, they are one of the few 'go anywhere' trains and the perfect single vehicle train for any layout. This outstanding model will feature eight separately switchable lighting functions, including illuminated door buttons, day/night headlights and interior lights. Other standard features include a factory fitted speaker, interchangeable BSI/magnetic bar couplers, snowploughs and a fully detailed interior. All models will be offered DCC Ready or with factory fitted DCC and sound.

Built by: Leyland Bus, Workington
Number built: 70
Number series: 153301-335/351-385
Service Career: 1991 onwards
Region: All
Purpose: Regional/Local Passenger
Status in 2025: 39 active, 1 preserved

DUE SPRING 2025! BR CLASS 153

No.	Description
53201	Regional Railways 153301 DCC READY
53203	Regional Railways 153301 DCC SOUND
53241	Stagecoach East Midlands Trains 153311 DCC READY
53243	Stagecoach East Midlands Trains 153311 DCC SOUND
53251	Northern 'Swoosh' 153351 DCC READY
53253	Northern 'Swoosh' 153351 DCC SOUND
53271	Transport for Wales Grey/Red 153906 DCC READY
53273	Transport for Wales Grey/Red 153906 DCC SOUND
53291	London Midland City 153356 DCC READY
53293	London Midland City 153356 DCC SOUND

- DCC READY
- 21 PIN
- SPEAKER FITTED
- WORKING LIGHTS
- INTERIOR LIGHTS
- NEM COUPLERS
- DCC FITTED
- SOUND FITTED

info



BR RAILCARS/DMUs



- 21 PIN
- DCC READY
- WORKING LIGHTS
- INTERIOR LIGHTS
- SPRUNG BUFFERS
- SOUND READY

BR CLASS 117 DMU

Class Profile: Built by BMC subsidiary Pressed Steel in Glasgow to replace ex-GWR '61XX' steam locomotives and hauled stock on suburban services from London Paddington, these successful and long-lived DMUs were characterised by their high-density design. With a door to most seating bays, passengers could alight and board quickly at the frequent stops along Thames Valley routes. In later years they also found work around Birmingham, in North London and on ScotRail services between Edinburgh and Fife in the 1990s.

Built by: Pressed Steel
Number built: 43
Number series: DMBS: W51332-373, TCL: W59484-522, DMS: W51374-51415
Service Career: 1960-99
Region: Western/Scottish
Purpose: Suburban passenger
Status in 2025: 55 vehicles preserved

BR CLASS 117 DMU

No.	Description
1173	BR Blue/Grey 2-car set W51371+W51413
1174	Network SouthEast 2-car set L702 51398+51356
1175	BR Green (speed whiskers) 3-car W51371+W59478+W51413
1176	BR Green (small yellow panel) 3-car W51373+W59480+W51415
1177	BR Blue (full yellow end) 3-car W51372+W59479+W51414
1178	BR Blue/Grey 3-car T306 51411+59521+51369
1179	Network SouthEast 3-car L421 51411+59521+51369



- 21 PIN
- DCC READY
- WORKING LIGHTS
- INTERIOR LIGHTS
- SPRUNG BUFFERS
- SOUND READY

BR CLASS 121 RAILCAR

Class Profile: Closely related to the Class 117 three-car sets, these single railcars followed in the footsteps of the very successful GWR AEC railcars, replacing their predecessors on the short branches linking various Thames Valley towns and villages with the Great Western Main Line. After the closure of some of these lines, the class was more widely distributed, with some moving to the West Midlands and Bristol. Ideally suited to short lines with light passenger traffic, small numbers remained in passenger and departmental use into the 2000s. They became Britain's longest serving DMU type in the 2010s, with the final pair not withdrawn by Chiltern Railways clocking up an impressive 57 years by the time they were finally withdrawn by Chiltern Railways in 2017.

Built by: Pressed Steel
Number built: 16
Number series: W55020-035
Service Career: 1960-2017
Region: Western/London Midland
Purpose: Suburban/rural passenger
Status in 2025: 13 preserved

BR/Pressed Steel Class 121 Railcar

No.	Description
1210	BR Green (speed whiskers) W55021
1211	BR Green (small yellow panel) W55027
1212	BR Blue (full yellow end) W55033
1213	BR Blue/Grey W55028
1214	Network SouthEast 55025
1215	GWR150 Chocolate/Cream W55020



BR CLASS 149 RAILCAR TRAILER

Built by: Pressed Steel
Number built: 10
Number series: W56280-289
Service Career: 1960-92
Region: Western
Purpose: Suburban passenger
Status in 2025: 2 preserved

BR/Pressed Steel Class 149 Railcar Trailer

No.	Description
1240	BR Green W56282
1241	BR Green (yellow panel) W56285
1242	BR Blue W56284
1243	BR Blue/Grey W54281
1244	Network SouthEast 54280

- 21 PIN
- DCC READY
- WORKING LIGHTS
- INTERIOR LIGHTS
- SPRUNG BUFFERS
- SOUND READY

BR CLASS 122 RAILCAR

Class Profile: Following in the footsteps of the GWR railcars, this class of single railcars was built for the Western Region in the West Midlands, although they also saw use in Scotland from the late-1960s and in Devon and Cornwall. Ideally suited to short lines with light passenger traffic, they also saw use as departmental and parcels vehicles. However, they were retired from passenger use by Regional Railways in 1995. Nine single-ended trailers were also built to work with the '122s' (see Class 150), providing additional seats on busier services.

Built by: Gloucester RCW
Number built: 20
Number series: W55000-019
Service Career: 1958-95
Region: London Midland/Western/Scottish
Purpose: Suburban/rural passenger
Status in 2025: 8 preserved

BR CLASS 122 RAILCAR Version 1 (1960s)

No.	Description
1220	BR Green W55000 (speed whiskers)
1221	BR Green M55005 (small yellow panel)
1222	BR Green W55017 (small yellow panel) WEATHERED

Version 1 (late-1960s/70s)

No.	Description
1225	BR Green W55004 (small yellow panel)
1226	BR Blue W55008 (small yellow panel)
1227	BR Blue TDB975227 (full yellow end) WEATHERED

Version 2 (1970s-90s)

No.	Description
1230	BR Blue SC55011 (full yellow ends)
1231	BR Blue/Grey M55009
1232	Regional Railways 55012



BR CLASS 150 RAILCAR TRAILER

Built by: Gloucester RCW
Number built: 9
Number series: W56291-299
Service Career: 1958-95
Region: London Midland/Western/Scottish
Purpose: Suburban/rural passenger
Status in 2025: Extinct

BR CLASS 150 RAILCAR TRAILER

No.	Description
1250	BR Green W56299
1251	BR Green (yellow panel) M56296
1252	BR Blue M56295
1253	BR Green W56292 small yellow panel) WEATHERED

BR MARK 1 COACHES



Vehicle Profile: BR's standard passenger coach of the 1950s and 1960s - introduced in 1951 but many are still in service today with charter operators and preserved railways. Our most recent models feature two new designs of bogie, the widely used

Commonwealth and B4 types, vastly expanding the range of liveries we can offer. InterCity, Regional Railways and Network SouthEast Mk1s are perfect companions for new O gauge locomotives such as our refurbished Class 31s, 33s, 37/4s, 45s, 47s and 50s.

Service Career: 1951 onwards
Region: All
Purpose: Express/secondary passenger
Use with: BR(W) 43XX/61XX, BR Class 17/20/24/25/26/27/31/33/35/37/40/42/45/47/50/52/53/55/73

TOURIST SECOND OPEN (TSO)



No.	Description
4915	Network SouthEast (B4)
4916	InterCity Executive (B4)
4917	Regional Railways (B4)

SECOND CORRIDOR (SK)



No.	Description
4903	Network SouthEast (Commonwealth)

BRAKE SECOND CORRIDOR (BSK)



No.	Description
4926	InterCity Executive (Commonwealth)
4927	Regional Railways (Commonwealth)

FIRST CORRIDOR (FK)



No.	Description
4934	InterCity Executive (B4)
4935	Regional Railways (B4)
4937	Network SouthEast (Commonwealth)

RESTAURANT MINIATURE BUFFET (RMB)



No.	Description
-	Check Stockists

REPLACEMENT MK1 BOGIES

No.	Description
4998	Pack of 2x B4 Bogies
4999	Pack of 2x Commonwealth Bogies



BR MK 1 GENERAL UTILITY VAN

Service Career: 1956 onwards
Number built: 907
Region: All
Purpose: Mail/Newspapers/Parcels/Motorail
Use with: BR(W) 43XX/61XX, BR Class 17/20/25/26/27/31/33/35/37/40/42/45/47/50/52/53/55/73



No.	Description
4986	Satlink Western Red/Yellow KDB977557 (BR1)*
4987	BR Blue W86370 WEATHERED (BR1)*
4988	BR Blue 'Newspapers' (BR1)*
4989	Rail express systems Red/Grey NOX (Commonwealth)*
4990	Royal Mail Red/Yellow (BR1)*
4992	BR Blue (BR1)*
4993	BR 'Express Parcels' Blue (BR1)*
4994	BR(S) Green (BR1)*
4995	BR 'Motorail' Blue/Grey (Commonwealth)
4996	InterCity Motorail (Commonwealth)
4997	Network SouthEast 93852 (BR1)



BR MK 1 BRAKE GANGWAYED (BG)

Service Career: 1951 onwards
Number built: 1,129
Region: All
Purpose: Luggage/Mail/Newspapers/Parcels
Use with: BR(W) 43XX/61XX, BR Class 02/03/17/20/25/26/27/31/33/35/37/40/42/45/47/50/52/53/55/73



No.	Description
4951	BR Maroon (BR1)*
4957	InterCity (B4)
4958	BR Blue/Grey (B4)
4959	Network Rail Yellow Generator Van (B4)*
4960	Railway Technical Centre (RTC) Red/Blue 'Laboratory 23' (B4)*
4961	Breakdown Train Unit Yellow/Black*
4962	Rail express systems Red/Grey NEX (Commonwealth)*
4963	Provincial Trans-Pennine E92058 (B4)*
4964	ScotRail 92088 (B4)*
4966	BR Blue/Grey M80877 WEATHERED (BR1)*
4967	BR Unlined Crimson E80638 (BR1)*



BR MK 1 COVERED CARRIAGE TRUCK (CCT)

Service Career: 1959 to mid-1980s
Region: All
Number built: 827
Purpose: Mail/parcels/newspapers/stores
Use with: Anything!
Features: Compensated axles, optional footsteps, pin-point bearings



No.	Description
9400	BR Lined Maroon
9401	BR Maroon Unlined
9402	BR Blue Unbranded
9403	BR Blue 'Red Star'
9404	BR Breakdown Train Yellow/Black
9405	BR Departmental Olive Green
9406	BR Lined Maroon M94799 WEATHERED
9407	BR Blue 'Express Parcels' W94476 WEATHERED
9408	'Tartan Arrow' Red/White M94170

BR MK2/MK2A COACHES



Vehicle Profile: Our range of British Rail rolling stock has expanded with a family of early MK2 coaches. Four variants cover First Corridor (FK), Brake

Second Open (BSO), Brake First Corridor (BFK) and Tourist Second Open (TSO) vehicles. The models can be configured as Mk2 or Mk2a variants using

the pack of customer-fit parts supplied with every model. After lengthy delays at the factory these Mk2s are out now in no fewer than 29 versions!

MK2/MK2A TOURIST SECOND OPEN (TSO)



No.	Description
2400	BR Blue/Grey Unbranded
2401	ScotRail
2402	Network SouthEast Light Blue
2403	Network SouthEast Dark Blue

No.	Description
2404	Hebridean Green/Cream
2405	Provincial Trans-Pennine
2406	Regional Railways
2407	West Coast Maroon



MK2/MK2A BRAKE FIRST CORRIDOR (BFK)



No.	Description
2420	BR Blue/Grey Unbranded
2421	Network SouthEast Light Blue
2422	Network SouthEast Dark Blue

No.	Description
2423	Regional Railways
2424	InterCity Executive

MK2/MK2A BRAKE SECOND OPEN (BSO)



No.	Description
2410	BR Blue/Grey Unbranded
2411	Network SouthEast Light Blue
2412	Network SouthEast Dark Blue
2413	Hebridean Green/Cream

No.	Description
2414	Provincial Trans-Pennine
2415	BR Blue/Grey with Micro-Buffer BSO(T)
2416	DRS 'Compass' Blue Escort Coach
2425	Network Rail Yellow DB977337



MK2/MK2A FIRST CORRIDOR (FK)



No.	Description
2430	BR Blue/Grey Unbranded
2431	Network SouthEast Light Blue
2432	Network SouthEast Dark Blue
2433	Provincial Trans-Pennine

No.	Description
2434	ScotRail 13424
2435	RTC Red/Blue Test Car 6
2436	BR(S) Green

DUE
MID
2025!

info

NEW! SOUTHERN RAILWAY PMV/CCT UTILITY VAN

Vehicle Profile: Many hundreds of these general purpose two-axle vans were built by the Southern Railway and BR over more than three decades. Two main versions were the Covered Carriage Truck (CCT) with folding end doors and Parcels & Miscellaneous Van (PMV) with fixed ends, but other variations in construction included even planks, uneven planks and plywood panels. Luggage, newspapers, mail and parcels traffic formed the bulk of their work but they also carried bicycles, pigeons and lightweight goods. Many passed into departmental use from the 1960s onwards, proving useful as storage, equipment and generator vans.

Service Career: 1920s to 1980s

Region: All

Purpose: Mail/parcels/newspapers/stores

Use with: Anything!

Features: Compensated axles, sprung buffers, optional footsteps, pin-point bearings

DUE MID-2025! SR CCT/PMV UTILITY VAN

No.	Description
9150	Southern Rly Green PMV No. 1171
9151	BR Crimson PMV S1058S
9152	BR(S) Green PMV S1626S
9153	BR Blue PMV S1574
9154	BR Blue PMV S1865 WEATHERED
9155	BR Gulf Red PMV ADS4
9156	BR Crimson PMV Cycle Van S1282S
9170	Southern Rly Green CCT S2372
9171	BR Crimson CCT S1765S WEATHERED
9172	BR(S) Green CCT S2376S
9173	BR Blue NOV S2017
9174	BR Departmental Olive Green CCT ADB975276
9175	BR Blue CCT S1733



info

LMS 50FT INSPECTION SALOON

Class Profile: Used for engineers' inspections, VIPs, meetings and district managers' tours of network, these classic LMS vehicles had seated saloons at each end with large windows to give a good all round view of the line. Between the saloons was a toilet and a small kitchen for preparing meals. The perfect one-coach train for O gauge layouts of all sizes, from depots to large exhibition layouts! This model features a detachable magnetic roof, which lifts off to reveal incredible interior detail. Our drop-in LED lighting bar can be installed in seconds to provide interior illumination.

Service Career: 1940s onwards

Region: All

Number built: 13

Purpose: Permanent way inspection/VIP transport

Use with: Anything!

AVAILABLE NOW! LMS INSPECTION SALOON

No.	Description
9105	InterCity 'Swift' DM45029
9106	ScotRail DM45020 (B4 bogies)
9107	LMS Crimson DM45030 (yellow ends)
9108	Loadhaul Black/Orange DM395280
9109	EWS Red/Gold 45029
9110	Regional Railways 999503
9111	BR Crimson/Cream (Yellow Ends)

'O' FREIGHT WAGONS



35 TON 'B' TANK

Service Career: 1950s-1980s

Region: All

Purpose: Fuel oil/diesel transport

BR TOPS code: Various

Use with: BR(W) 43XX/61XX, BR Class 02/03/05/17/20/24/25/26/27/31/33/35/37/40/42/45/47/50/52/53/73



35 TON 'B' TANK

No.	Description
1010	ESSO Black (early) 3305
1011	ESSO Black (early) 3328
1012	ESSO Black (alt livery) 3373
1013	ESSO Black (alt livery) 3650
1014	Regent Black 323
1015	Regent Black 409
1016	BR 'Waste Oil' Black ADB999041
1017	BR Departmental Yellow LDB998933
1018	BR Departmental Olive Green ADB999090
1019	ESSO 'Lube Traffic Only' Black 44216
1020	ESSO Black (unbranded) 43506
1021	ESSO Black (unbranded) 43784
1022	ICI Molasses Red/Grey 48559
1023	ICI Molasses Red/Grey 48623
1024	ICI Chemicals Grey/Orange 384



BR 'CATFISH' HOPPER

Number Built: 716

Service Career: 1954-2006

Region: LMR/NER/ER/ScR

Purpose: Ballast hopper

BR TOPS code: ZEV

Use with: Class 02/03/17/20/24/25/31/35/37/40/47/52/73



BR 'CATFISH' BALLAST HOPPER

No.	Description
4354	BR Black DB983754
4355	BR Olive DB992624 WEATHERED
4356	BR Olive (late) DB983473
4357	BR Civil Engineers Grey/Yellow ZEV DB992559
4358	BR Civil Engineers Grey/Yellow ZEV DB992579
4359	BR Civil Engineers Yellow ZEV DB983503
4360	BR Civil Engineers Grey/Yellow ZCV 'Puffin' DB983872
4361	BR Olive DB983860 WEATHERED
4362	BR Gulf Red DB992661 WEATHERED



BR 'DOGFISH' HOPPER

Number Built: 1,249

Service Career: 1955-2006

Region: All

Purpose: Ballast hopper

BR TOPS code: ZFV

Use with: BR(W) 43XX/61XX, BR Class 02/03/17/20/24/25/26/27/31/33/35/37/40/42/45/50/52/73



BR 'DOGFISH' BALLAST HOPPER

No.	Description
4379	BR Black DB993952
4380	BR Olive (late) DB983195
4381	BR Olive (early) DB993413 WEATHERED
4382	BR Black DB992748 (NE markings)
4383	BR Gulf Red ZFV DB983217
4384	BR Civil Engineers Grey/Yellow ZFV DB993016
4385	BR Civil Engineers Grey/Yellow ZFV DB983210
4385	BR Civil Engineers Grey/Yellow ZFV DB993331 WEATHERED
4387	BR Civil Engineers Grey/Yellow ZFV DB983192 (Mainline branding)
4388	Loadhaul black/orange ZFV DB993111

KITS & ACCESSORIES FOR O AND OO GAUGE

Complement your HELJAN models with high-quality building kits, available from your local model railway shop now.



PCA TANKS



Class Profile: For more than four decades, these classic wagons have been transporting bulk cement and powdered chemicals around Britain. Running singly or in block trains of up to 30 wagons, they are one of the most recognisable freight vehicles of the BR and privatisation era. Our outstanding new PCA features a wealth of fine body and chassis detail, sprung buffers and Instanter couplings. With 10 individually numbered and decorated cement wagons plus three colourful chemical wagons, there's something for everyone.

Service Career: 1970s onwards

Region: All

Purpose: Bulk powder transport

Use with: BR Class 02/03/20/25/26/27/31/33/37/40/45/47/50/56/58/73

AVAILABLE NOW! PCA POWDER TANKS

No.	Description
1060	BCC Grey 10800 (Era 8)
1061	BCC Grey 10894 (Era 8)
1062	BCC Grey 10747 (Era 8)
1063	BCC Grey 10739 (Era 8)
1064	BCC Grey 10777 (Era 9)
1065	BCC Grey 10770 (Era 8)
1066	BCC Grey 10762 (Era 8)
1067	BCC Grey 10749 (Era 9)
1068	BCC Grey 10738 (Era 8)
1069	BCC Grey 10888 (Era 8)
1078	TRL/Lever Bros. Purple 10525 (Era 8)
1090	Albright & Wilson TRL10530 (Era 8)
1091	Albright & Wilson PR9498 (Era 8)

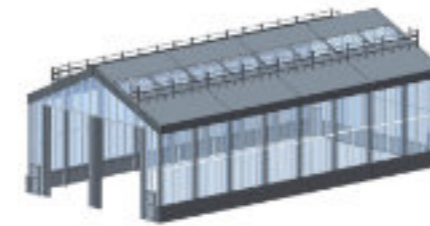

O GAUGE DIESEL DEPOT KIT

No.	Description
9500	Modern Diesel Depot
9501	Modern Diesel Depot Kit
9502	Modern Diesel Depot extension end sections

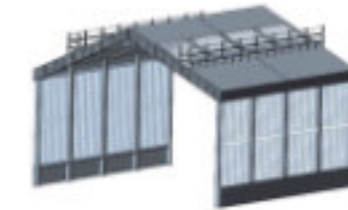

O GAUGE DIESEL DEPOT KIT EXTENSION - SIDES

No.	Description
9501	Diesel Depot Extension



O GAUGE DIESEL DEPOT KIT - ENDS

No.	Description
9502	Modern Diesel Depot extension end sections



OO TACKLEY HALT MODERN STATION KIT

No.	Description
2501	Tackley Halt kit



OO MOTORISED 27.4 METRE (90FT) TURNTABLE

Product information: This superb OO gauge, electronically operated, DCC compatible turntable features a detailed deck, weathered one-piece pit and motorised drive gear. Locomotives up to 320mm (12in) long can be accommodated and the programmable indexing system allows up to 58 track positions. Can be used with analogue control or DCC systems without requiring a separate decoder. *The turntable requires a baseboard hole of 350mm with 57mm clearance below the pit.*



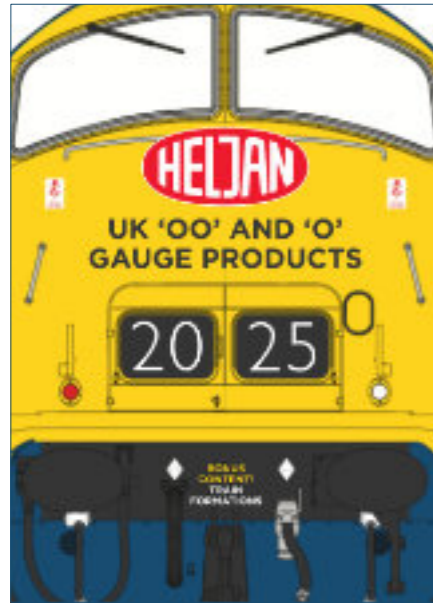

Heljan A/S
Rebslagervej 6,
DK-5471,
Søndersø,
Denmark
e: heljan@heljan.dk

 Search for [Heljan A/S](#)

www.heljan.co.uk

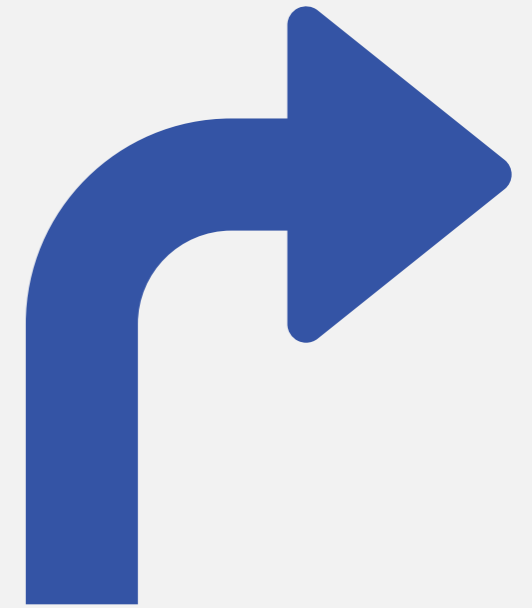

**PLEASE
TURN
OVER**



TRAIN BUILDER - O GAUGE

As the HELJAN range of O gauge rolling stock grows, the possibilities for assembling authentic train formations expand every year. The trains suggested below are based on typical period trains from the last 60 years using HELJAN models available now or due for release in 2021.

BR SPEEDLINK FREIGHT 1986



OIL TRAIN - SOUTHERN REGION 1960s



FAR NORTH LINE 1981



NETWORK SOUTHEAST THAMES & CHILTERN 1988



PARCELS SECTOR 1993



WESTERN REGION SEMI-FAST 1964



BR PARCELS EARLY-1970S



EAST COAST EXPRESS LATE-1960s



PACER REPLACEMENT LATE-1980s



EXETER-BARNSTAPLE DMU REPLACEMENT 1990



NORTH EASTERN REGION BALLAST TRAIN MID-1960s



INVERNESS-KYLE OF LOCHALSH 1988



TRAIN BUILDER - O GAUGE

As the HELJAN range of O gauge rolling stock grows, the possibilities for assembling authentic train formations expand every year. The trains suggested below are based on classic period trains from the last 60 years using HELJAN models available now or due for release in 2022.

MANCHESTER-CLEETHORPES 1984



REGIONAL RAILWAYS NORTH WEST EARLY-1990s



SPEEDLINK MOD TRAIN EARLY-1990s



LIVERPOOL-NEWCASTLE LATE-1980s



LMR BALLAST TRAIN EARLY-1990s



EDINBURGH-GLASGOW MID-1970s



KING'S CROSS-EDINBURGH EARLY-1970s



EUSTON-PWLLHELI LATE-1980s



'THE HEBRIDEAN' - INVERNESS-KYLE OF LOCHALSH 1990



TEESSIDE OIL TRAIN MID-1960s



WESTERN REGION EXPRESS 1965



BR STEEL TRAIN MID-1980s



WATERLOO-SALISBURY 1990



TINTERN QUARRY BALLAST TRAIN 1966



TRAIN BUILDER - O GAUGE

As the HELJAN range of O gauge rolling stock grows, the possibilities for assembling authentic train formations expand every year. The trains suggested below are based on classic period trains from the last 60 years using HELJAN models available now or due for release in 2023.

MANCHESTER-CLEETHORPES 1984



REGIONAL RAILWAYS NORTH WEST EARLY-1990s



TEESSIDE OIL TRAIN MID-1960s



TRANS-PENNINE LIVERPOOL-NEWCASTLE 1987



EDINBURGH-GLASGOW MID-1970s



ScR BALLAST TRAIN EARLY-1990s



KING'S CROSS-EDINBURGH EARLY-1970s



BR PARCELS MID-1970s

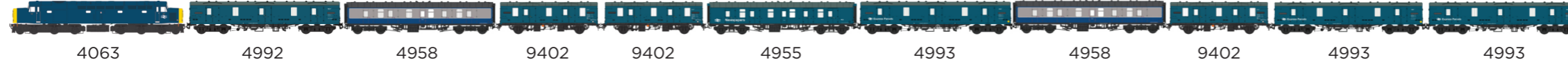

'THE HEBRIDEAN' - INVERNESS-KYLE OF LOCHALSH 1990



PADDINGTON SUBURBAN EARLY-1960s



WESTERN REGION EXPRESS 1964



BIRMINGHAM SUBURBAN LATE-1960s



INVERNESS-KYLE OF LOCHALSH 1975

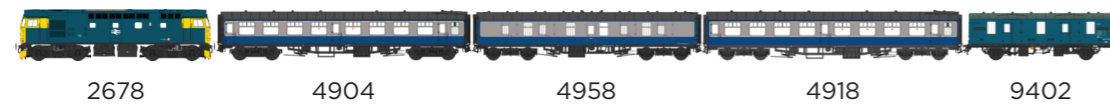

REGENT OIL TRAIN EARLY-1960s



WATERLOO-SALISBURY 1990



TINTERN QUARRY BALLAST TRAIN 1966

